



24 SEPTEMBER 2013

ORDINARY MEETING

MINUTES

CONTENTS

1. OPENING	1
2. ATTENDANCE, APOLOGIES AND LEAVE OF ABSENCE	1
2.1 Members Present.....	1
2.2 Staff In Attendance	1
2.3 Observers And Visitors	1
2.4 Apologies and Approved Leave of Absence	1
2.5 Condolences	1
3. RESPONSE TO PREVIOUS PUBLIC QUESTIONS TAKEN ON NOTICE	1
4. PUBLIC QUESTION TIME	1
5. APPLICATIONS FOR LEAVE OF ABSENCE	1
6. DECLARATIONS OF INTEREST	1
7. CONFIRMATION OF MINUTES	2
7.1 Minutes Of The Ordinary Council Meeting Held 27 August 2013.....	2
8. TECHNICAL SERVICES	3
8.1 Bitumen Tender	3
9. PLANNING SERVICES	5
9.1 Notice of Application for Exploration Licence 70/4532	5
9.2 Notice of Application for Exploration Licence 70/4533	12
9.3 Application – Outbuilding (Storage Shed) Lot 16914 Blechy’s Road	19
9.4 Application – Outbuilding (Garage) 23 (Lot 19) Hunt Road.....	25
9.5 Application – Special Event (Westdale Dirt Drags) Lot 83 Butchers Road.....	30
10. BUILDING SERVICES & ENVIRONMENTAL HEALTH SERVICES	57
11. FINANCE	58
11.1 Monthly Financial Report	58
11.2 Accounts Paid by Authority	69
12. ADMINISTRATION	81
12.1 Repairs to Former Child Health Clinic, 141 Vincent Street.....	81
12.2 Independent Living Units.....	86
12.3 Authorised Officers – Cat Act 2011	89
12.4 Community Sporting and Recreation Facilities Fund Grant Application	92
13. NEW BUSINESS ARISING BY ORDER OF THE MEETING	94
14. CLOSURE	94

1. OPENING

The Chairperson declared the meeting open at 2:08 pm

2. ATTENDANCE, APOLOGIES AND LEAVE OF ABSENCE

2.1 Members Present

Cr DJ Ridgway	President	South Ward
Cr CJ Pepper	Deputy President	West Ward
Cr JD Alexander		North Ward
Cr BM Foster		West Ward
Cr PJ Gogol		North Ward
Cr KM Murray		North Ward
Cr LC Shaw		West Ward
Cr DC White		South Ward

2.2 Staff In Attendance

Mr SP Gollan	Chief Executive Officer	
Mr SK Marshall	Deputy Chief Executive Officer	
Mrs A Lewis	Executive Assistant	
Mr BS de Beer	Shire Planner	(from 2:12pm to 2:20pm)

2.3 Observers And Visitors

Mr Dean Adams in relation to Item 9.5	(from 2:08pm to 2:20pm)
---------------------------------------	-------------------------

2.4 Apologies and Approved Leave of Absence

Nil

2.5 Condolences

Nil

3. RESPONSE TO PREVIOUS PUBLIC QUESTIONS TAKEN ON NOTICE

Nil

4. PUBLIC QUESTION TIME

Nil

5. APPLICATIONS FOR LEAVE OF ABSENCE

Nil

6. DECLARATIONS OF INTEREST

Nil

7. CONFIRMATION OF MINUTES

7.1 Minutes Of The Ordinary Council Meeting Held 27 August 2013

OFFICER'S RECOMMENDATION

That the Minutes of the Ordinary Council Meeting held Tuesday 27 August 2013 be confirmed.

COUNCIL RESOLUTION

M1/0913

Moved Cr Alexander

Seconded Cr Murray

That the Minutes of the Ordinary Council Meeting held Tuesday 27 August 2013 be confirmed.

CARRIED 8/0

8. TECHNICAL SERVICES

8.1 Bitumen Tender

SUBMISSION TO: Ordinary Council Meeting 24 September 2013
REPORT DATE: 18 September 2013
APPLICANT: N/A
FILE REFERENCE: ADM 0436
AUTHOR: S P Vincent, Manager of Works
ATTACHMENTS: Nil

SUMMARY

Council to award the Bitumen Tender.

BACKGROUND

Tenders were called for the supply and delivery of bitumen products and services using Walga's Eqnotes system and closed on 17 September 2013.

COMMENT

The following tender prices were received

	OVER 25,000 Litres per day Primer Seal	Full Construction Reseals (excluding aggregate supply)	
	(95/5) \$ per L	contract \$ per m ²	Spreader truck / hr
RNR CONTRACTING	1.13	3.42	120
BORAL	1.15	3.11	120
BITUMEN SURFACING	1.30	4.15	120

These prices equate to the following overall estimated costs for this years proposed works.

	Primer 92,140 litres	Reseals 73,010 M ²	TOTALS
RNR CONTRACTING	\$ 104,118	\$ 249,694	\$ 353,812
BORAL	\$ 105,961	\$ 227,061	\$ 333,022
BITUMEN SURFACING	\$ 119,782	\$ 302,992	\$ 422,774

In recent years we have used both RnR Contracting and Boral for our bitumen work. They are both equally competent and capable of undertaking these works. The outcome from the evaluation scorecard has shown Boral to come out in front due to their lower rates for the reseals.

STATUTORY ENVIRONMENT

Local Government Act 1995 and Local Government (Functions and General) Regulations 1996, Shire of Beverley Procurement Policy.

FINANCIAL IMPLICATIONS

Funds for bitumen works have been included in the 2013/14 budget

STRATEGIC IMPLICATIONS

Built Environment – Maintain and upgrade our assets and infrastructure.

POLICY IMPLICATIONS

Nil

VOTING REQUIREMENTS

Absolute majority.

OFFICER'S RECOMMENDATION

That Council accept the tender from Boral for the supply of bitumen products and services as tendered. Primer seal \$ 1.15 per litre, full contract reseals (less aggregate) at \$3.15 per square metre and truck hire \$120 per hour.

COUNCIL RESOLUTION

M2/0913

Moved Cr Pepper

Seconded Cr Gogol

That Council accept the tender from Boral for the supply of bitumen products and services as tendered. Primer seal \$ 1.15 per litre, full contract reseals (less aggregate) at \$3.15 per square metre and truck hire \$120 per hour.

CARRIED 8/0

2:12pm – Shire Planner Stefan de Beer joined the meeting.

9. PLANNING SERVICES

9.1 Notice of Application for Exploration Licence 70/4532

SUBMISSION TO:	Ordinary Council Meeting 24 September 2013
REPORT DATE:	16 September 2013
APPLICANT:	M & M Walter Consulting
FILE REFERENCE:	ADM 0071
AUTHOR:	B S de Beer, Shire Planner
ATTACHMENTS:	Application Documentation

SUMMARY

M&M Walter Consulting mining titles and native title management advised that they have made application for an exploration license.

BACKGROUND

The following Notice of Application for an Exploration License has been received for Council's information:

East Pilbara Iron Pty Ltd

70/4532

A copy of the map of the areas to be explored is attached.

COMMENT

Section 120(1) of the Mining Act, 1978 reads as follows:

'In considering any application for the grant of a mining tenement the Minister, warden or mining registrar, as the case requires, shall take into account the provisions of any planning scheme in force under the Planning and Development Act 2005 affecting the use of the land concerned, but the provisions of any such scheme shall not operate to prohibit or affect the granting of a mining tenement or the carrying out of any mining operations authorised by this Act.'

As a result of the above it will be recommended that Council resolve to give appropriate advice notes in relation to their desired intended outcomes for exploration activities within the Shire of Beverley.

STATUTORY ENVIRONMENT

Exploration licences are dealt with under the Mining Act, 1978.

FINANCIAL IMPLICATIONS

Nil

STRATEGIC IMPLICATIONS

Nil

POLICY IMPLICATIONS

Nil

VOTING REQUIREMENTS

Simple majority.

OFFICER'S RECOMMENDATION

That Council resolve to inform M&M Walter Consulting that they take note of the exploration licence application 70/4532 and further advise as follows: –

1. All service holes drilled for the purpose of exploration are to be capped, filled or otherwise made safe after completion.
2. All costeans and other disturbances to the surface of the land made as a result of exploration, including drill pads, grid lines and access tracks, being backfilled and rehabilitated to the satisfaction of the district mining engineer. Backfilling and rehabilitation being required no later than six months after excavation unless approved by the district mining engineer.
3. Abandoned equipment and temporary buildings being removed from the mining tenement prior to or at the termination of the exploration program.
4. No activities taking place to the detriment of any roads, streets or verges.
5. Minimum disturbances being made to the natural vegetation.
6. Adequate suppression control methods and practices being used.
7. Except with the approval of the Shire of Beverley, all mining excavations or drilling operations being backfilled and the ground reinstated and revegetated to the satisfaction of the Shire of Beverley's Works Supervisor.
8. All works comply with the Environmental Protection (Noise) Regulations 1997.
9. All waste materials, rubbish and plastic sample bags to be removed within 60 days of placement.

COUNCIL RESOLUTION

M3/0913

Moved Cr Pepper

Seconded Cr Shaw

That Council resolve to inform M&M Walter Consulting that they take note of the exploration licence application 70/4532 and further advise as follows: –

- 1. All service holes drilled for the purpose of exploration are to be capped, filled or otherwise made safe after completion.**
- 2. All costeans and other disturbances to the surface of the land made as a result of exploration, including drill pads, grid lines and access tracks, being backfilled and rehabilitated to the satisfaction of the district mining engineer. Backfilling and rehabilitation being required no later than six months after excavation unless approved by the district mining engineer.**
- 3. Abandoned equipment and temporary buildings being removed from the mining tenement prior to or at the termination of the exploration program.**
- 4. No activities taking place to the detriment of any roads, streets or verges.**
- 5. Minimum disturbances being made to the natural vegetation.**
- 6. Adequate suppression control methods and practices being used.**
- 7. Except with the approval of the Shire of Beverley, all mining excavations or drilling operations being backfilled and the ground reinstated and revegetated to the satisfaction of the Shire of Beverley's Works Supervisor.**
- 8. All works comply with the Environmental Protection (Noise) Regulations 1997.**
- 9. All waste materials, rubbish and plastic sample bags to be removed within 60 days of placement.**

CARRIED 8/0

Attachment 9.1

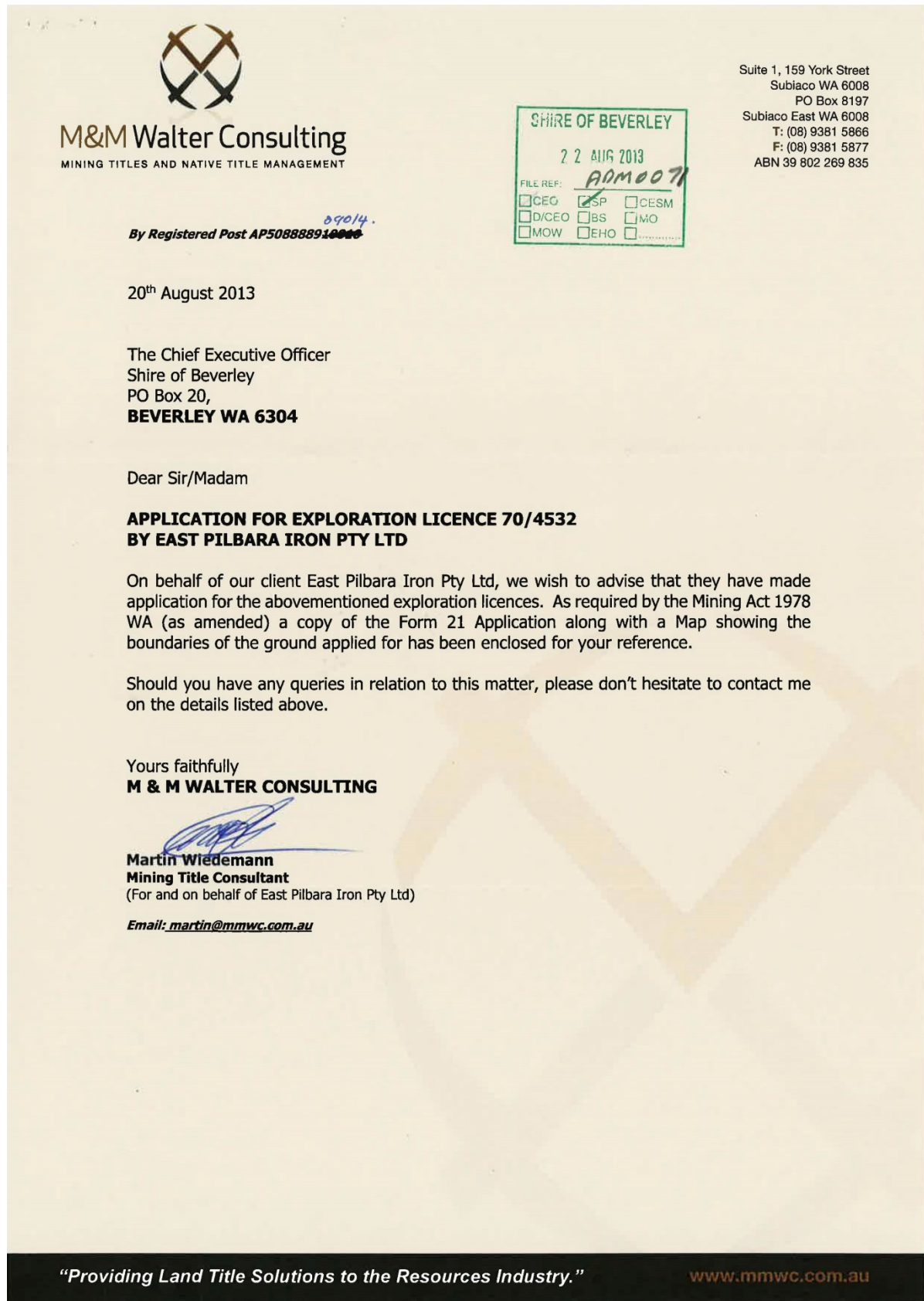

Attachment 9.1

FORM 21 WESTERN AUSTRALIA
Mining Act 1978
(Secs. 41, 58, 70C, 74, 86, 91, Reg. 64)

APPLICATION FOR MINING TENEMENT

- (a) Type of tenement
- (b) Time & Date marked out (where applicable)
- (c) Mineral Field

(a) Exploration Licence	No. <u>70, 4532</u>	
(b) a.m./p.m. / /	(c) South West	

- APPLICANT:
For each applicant:
(d) Full name and ACN/ABN No.
(e) Address
(f) No. of shares
(g) Total No. of shares

(d) & (e)	(f) shares
East Pilbara Iron Pty Ltd (ACN 153 537 485)	100
c/- M & M Walter Consulting	
PO Box 8197	
Subiaco East WA 6008	
(g) total	100

- DESCRIPTION OF GROUND APPLIED FOR:
(For Exploration Licences see Note 1.
For other Licences see Note 2.
For all Licences see Note 3.)
(h) Locality
(i) Datum Peg
(j) Boundaries

(h) Dulbellong
(i) See Attachments 1 & 2
(j)
"Applicant seeks subsurface rights only in respect to any private land affect by the application."
(k) 70 Blocks

- (k) Area (ha or km²)
- (l) Signature of applicant or agent (if agent, state full name and address)

(l) *Susan McKay* Date 08 August 2013
Susan McKay (as Agent)
 M & M Walter Consulting
 PO Box 8197, Subiaco WA 6008

OFFICIAL USE

A NOTICE OF OBJECTION may be lodged at any mining registrar's office on or before the 13 day of August 2013. (See Note 4).

Where an objection to this application is lodged the hearing will take place on a date to be set.

Received at 9:45 a.m. /p.m. on 9-5 2013 with fees of:
 Application \$ 1,257.55
 Rent \$ 8,330.00
 TOTAL \$ 9,587.55

NOTES

- Note 1: EXPLORATION LICENCE
 (i) Attachments 1 and 2 form part of every application for an exploration licence and must be lodged with this form in lieu of (h), (i), (j) and (k).
 (ii) An application for an Exploration Licence shall be accompanied by a statement specifying method of exploration and technical and financial ability of the applicant(s).
 Note 2: PROSPECTING/MISCELLANEOUS LICENCE AND MINING/GENERAL PURPOSE LEASE
 (i) This application form shall be accompanied by a map on which are clearly delineated the boundaries of the area applied for.
 Note 3: GROUND AVAILABILITY
 (i) The onus is on the applicant to ensure that ground is available to be marked out and/or applied for.
 (ii) The following action should be taken to ascertain ground availability:
 (a) public plan search; (b) register search; (c) ground inspection.
 Note 4: ALL APPLICATIONS OVER PRIVATE LAND
 The period for lodgement of an objection is within 21 days of service of this notice, or the date noted above for lodging objections, whichever is the longer period.

9.2 Notice of Application for Exploration Licence 70/4533

SUBMISSION TO: Ordinary Council Meeting 24 September 2013
REPORT DATE: 16 September 2013
APPLICANT: M & M Walter Consulting
FILE REFERENCE: ADM 0071
AUTHOR: B S de Beer, Shire Planner
ATTACHMENTS: Application Documentation

SUMMARY

M&M Walter Consulting mining titles and native title management advised that they have made application for an exploration license.

BACKGROUND

The following Notice of Application for an Exploration License has been received for Council's information:

Kaolin Resources Pty Ltd

70/4533

A copy of the map of the areas to be explored is attached.

COMMENT

Section 120(1) of the Mining Act, 1978 reads as follows:

'In considering any application for the grant of a mining tenement the Minister, warden or mining registrar, as the case requires, shall take into account the provisions of any planning scheme in force under the Planning and Development Act 2005 affecting the use of the land concerned, but the provisions of any such scheme shall not operate to prohibit or affect the granting of a mining tenement or the carrying out of any mining operations authorised by this Act.'

As a result of the above it will be recommended that Council resolve to give appropriate advice notes in relation to their desired intended outcomes for exploration activities within the Shire of Beverley.

STATUTORY ENVIRONMENT

Exploration licences are dealt with under the Mining Act, 1978.

FINANCIAL IMPLICATIONS

Nil

STRATEGIC IMPLICATIONS

Nil

POLICY IMPLICATIONS

Nil

VOTING REQUIREMENTS

Simple majority.

OFFICER'S RECOMMENDATION

That Council resolve to inform M&M Walter Consulting that they take note of the exploration licence application 70/4533 and further advise as follows: –

1. All service holes drilled for the purpose of exploration are to be capped, filled or otherwise made safe after completion.
2. All costeans and other disturbances to the surface of the land made as a result of exploration, including drill pads, grid lines and access tracks, being backfilled and rehabilitated to the satisfaction of the district mining engineer. Backfilling and rehabilitation being required no later than six months after excavation unless approved by the district mining engineer.
3. Abandoned equipment and temporary buildings being removed from the mining tenement prior to or at the termination of the exploration program.
4. No activities taking place to the detriment of any roads, streets or verges.
5. Minimum disturbances being made to the natural vegetation.
6. Adequate suppression control methods and practices being used.
7. Except with the approval of the Shire of Beverley, all mining excavations or drilling operations being backfilled and the ground reinstated and revegetated to the satisfaction of the Shire of Beverley's Works Supervisor.
8. All works comply with the Environmental Protection (Noise) Regulations 1997.
9. All waste materials, rubbish and plastic sample bags to be removed within 60 days of placement.

COUNCIL RESOLUTION

M4/0913

Moved Cr Murray

Seconded Cr Gogol

That Council resolve to inform M&M Walter Consulting that they take note of the exploration licence application 70/4533 and further advise as follows: –

- 1. All service holes drilled for the purpose of exploration are to be capped, filled or otherwise made safe after completion.**
- 2. All costeans and other disturbances to the surface of the land made as a result of exploration, including drill pads, grid lines and access tracks, being backfilled and rehabilitated to the satisfaction of the district mining engineer. Backfilling and rehabilitation being required no later than six months after excavation unless approved by the district mining engineer.**
- 3. Abandoned equipment and temporary buildings being removed from the mining tenement prior to or at the termination of the exploration program.**
- 4. No activities taking place to the detriment of any roads, streets or verges.**
- 5. Minimum disturbances being made to the natural vegetation.**
- 6. Adequate suppression control methods and practices being used.**
- 7. Except with the approval of the Shire of Beverley, all mining excavations or drilling operations being backfilled and the ground reinstated and revegetated to the satisfaction of the Shire of Beverley's Works Supervisor.**
- 8. All works comply with the Environmental Protection (Noise) Regulations 1997.**
- 9. All waste materials, rubbish and plastic sample bags to be removed within 60 days of placement.**

CARRIED 8/0

Attachment 9.2

M&M Walter Consulting
MINING TITLES AND NATIVE TITLE MANAGEMENT

Suite 1, 159 York Street
Subiaco WA 6008
PO Box 8197
Subiaco East WA 6008
T: (08) 9381 5866
F: (08) 9381 5877
ABN 39 802 269 835

By Registered Post AP508888907010

20th August 2013

The Chief Executive Officer
Shire of Beverley
PO Box 20,
BEVERLEY WA 6304



Dear Sir/Madam

**APPLICATION FOR EXPLORATION LICENCE 70/4533
BY KAOLIN RESOURCES PTY LTD**

On behalf of our client Kaolin Resources Pty Ltd, we wish to advise that they have made application for the abovementioned exploration licences. As required by the Mining Act 1978 WA (as amended) a copy of the Form 21 Application along with a Map showing the boundaries of the ground applied for has been enclosed for your reference.

Should you have any queries in relation to this matter, please don't hesitate to contact me on the details listed above.

Yours faithfully
M & M WALTER CONSULTING

Martin Wiedemann
Mining Title Consultant
(For and on behalf of Kaolin Resources Pty Ltd)
Email: martin@mmwc.com.au

"Providing Land Title Solutions to the Resources Industry." www.mmwc.com.au

Application 9.2

FORM 21 WESTERN AUSTRALIA
Mining Act 1978
(Secs. 41, 58, 70C, 74, 86, 91, Reg. 64)

APPLICATION FOR MINING TENEMENT

- (a) Type of tenement
- (b) Time & Date marked out (where applicable)
- (c) Mineral Field

(a) Exploration Licence	No. <u>70.4533</u>
(b) a.m./p.m. / /	(c) South West

- APPLICANT:
For each applicant:
- (d) Full name and ACN/ABN No.
 - (e) Address
 - (f) No. of shares
 - (g) Total No. of shares

(d) & (e)	(f) shares
Kaolin Resources Pty Ltd (ACN 141 831 914)	100
c/- M & M Walter Consulting	
PO Box 8197	
Subiaco East WA 6008	
(g) total	100

- DESCRIPTION OF GROUND APPLIED FOR:
(For Exploration Licences see Note 1.
For other Licences see Note 2.
For all Licences see Note 3.)
- (h) Locality
 - (i) Datum Peg
 - (j) Boundaries

(h) Doobelling Spring
(i) See Attachments 1 & 2
(j)
"Applicant seeks subsurface rights only in respect to any private land affect by the application."
(k) 62 Blocks

- (k) Area (ha or km²)
- (l) Signature of applicant or agent (if agent, state full name and address)

(l) *S. McKay* Date 08 August 2013
Susan McKay (as Agent)
 M & M Walter Consulting
 PO Box 8197, Subiaco WA 6008

OFFICIAL USE

A NOTICE OF OBJECTION may be lodged at any mining registrar's office on or before the 13 day of Sept 2013 (See Note 4).

Where an objection to this application is lodged the hearing will take place on a date to be set.

Received at 2 45 a.m./p.m. on 9. 8. 20/13 with fees of:
 Application \$ 1,257.55
 Rent \$ 7,378.00
 TOTAL \$ 8,635.55

S. M. WALTER Mining Registrar

NOTES

- Receipt 06-127214
- Note 1: EXPLORATION LICENCE
 - (i) Attachments 1 and 2 form part of every application for an exploration licence and must be lodged with this form in lieu of (ii) (b) and (c) above.
 - (ii) An application for an Exploration Licence shall be accompanied by a statement specifying method of exploration, details of the proposed work programme, estimated cost of exploration and technical and financial ability of the applicant(s).
 - Note 2: PROSPECTING/MISCELLANEOUS LICENCE AND MINING/GENERAL PURPOSE LEASE
 - (i) This application form shall be accompanied by a map on which are clearly delineated the boundaries of the area applied for.
 - Note 3: GROUND AVAILABILITY
 - (i) The onus is on the applicant to ensure that ground is available to be marked out and/or applied for.
 - (ii) The following action should be taken to ascertain ground availability:
 - (a) public plan search; (b) register search; (c) ground inspection.
 - Note 4: ALL APPLICATIONS OVER PRIVATE LAND
 - The period for lodgement of an objection is within 21 days of service of this notice, or the date noted above for lodging objections, whichever is the longer period.

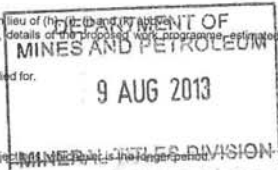

9.3 Application – Outbuilding (Storage Shed) Lot 16914 Blechy’s Road

SUBMISSION TO: Ordinary Council Meeting 24 September 2013
REPORT DATE: 17 September 2013
APPLICANT: KF Dunnett
FILE REFERENCE: BLE 51152
AUTHOR: B S de Beer, Shire Planner
ATTACHMENTS: Locality Map, Site Plan and Elevation Plan

SUMMARY

An application has been received to construct a Zincalume Outbuilding (Storage Shed), in extent 405m² at Lot 16914 Blechy’s Road, East Beverley. It will be recommended the application be approved.

BACKGROUND

In terms of the Shire’s Outbuilding Policy, the preference is to not have Zincalume Outbuildings in the Farming Zone closer than 75 meters from a Road Boundary. The proposed Outbuilding will be located approximately 40 meters from the Road Boundary of Blechy’s Road. The Proposed outbuilding is also 5m² larger than the permitted 400m² maximum permitted footprint area for Outbuildings in this Zone.

The subject site is located at Lot 16914 Blechy’s Road, East Beverley, is 85.5 Ha in extent and zoned Farming.

COMMENT

Zincalume cladding for walls and roofs are excluded from material to be used in Outbuilding Construction in the Shire’s Outbuilding Policy. Although the Outbuilding Policy is silent on the reason for this exclusion, it is presumably related to, amongst others, aesthetic concerns.

The Shire of Beverley Town Planning Scheme No. 2 (TPS 2) in Clause 4.13.1 states as follows:

‘No person shall without first having obtained the approval of the Council erect or commence to erect a building which by virtue of colour or type of materials, architectural style, height, bulk or ornamental or general appearance has in the opinion of the Council an exterior design which is out of harmony with the exterior designs of existing buildings or is likely to injure the amenity of the locality.’

When considering the aesthetic aspects of a proposed development involving Zincalume cladding, Shire Staff is of the opinion that the following aspects of the development should be taken into consideration:

- a) The specific siting of the Outbuilding on the property;
- b) The general character of the immediate area;
- c) The use of landscaping features to screen the development.

It is the opinion that the proposed siting of the Outbuilding at the subject property is such that it will not have any negative impact on the amenity of the property. Existing natural vegetation/landscaping, site specific topography and the distance from the closest major road, being Clulow Road, combine to effectively mitigate any

negative impact that the proposed development might have. Likewise, the marginal increase of 5m² beyond the maximum permitted 400m² permitted in terms of the Outbuilding Policy is such that no negative impact is anticipated. It is considered that the proposed development will be in pace with the character of the area.

Given the above site specific considerations it is not anticipated that the granting of Planning Approval for this application will create an undesirable precedent.

CONSULTATION

No consultation was deemed required.

STATUTORY ENVIRONMENT

The application may be approved under the Shire of Beverley's Town Planning Scheme No. 2.

FINANCIAL IMPLICATIONS

Nil

STRATEGIC IMPLICATIONS

Nil

POLICY IMPLICATIONS

Nil

VOTING REQUIREMENTS

Simple majority.

OFFICER'S RECOMMENDATION

That Council resolve to grant planning approval for an Outbuilding (Storage Shed) at Lot 16914 Blechy's Road, East Beverley, subject to the following conditions and advice notes:

Conditions:

1. If the development, the subject of this approval, is not SUBSTANTIALLY COMMENCED within a period of 2 years from the date of this approval being granted, the approval shall lapse and be of no further effect. Where an approval has lapsed, no development shall be carried out without the further approval of the responsible authority having first been sought and obtained.
2. Development shall be carried out only in accordance with the terms of the application as approved herein and any approved plan, prepared by the applicant and endorsed by Council's Shire Planner.
3. The outbuilding shall not be used for human habitation, commercial or industrial purposes.

Advice Notes:

1. Nothing in the approval or these conditions shall excuse compliance with all relevant written laws in the commencement and carrying out of the development.
2. The applicant is advised a building permit is required prior to commencement of any building works.

COUNCIL RESOLUTION

M5/0913

Moved Cr Shaw

Seconded Cr Gogol

That Council resolve to grant planning approval for an Outbuilding (Storage Shed) at Lot 16914 Blechy's Road, East Beverley, subject to the following conditions and advice notes:

Conditions:

1. If the development, the subject of this approval, is not **SUBSTANTIALLY COMMENCED** within a period of 2 years from the date of this approval being granted, the approval shall lapse and be of no further effect. Where an approval has lapsed, no development shall be carried out without the further approval of the responsible authority having first been sought and obtained.
2. Development shall be carried out only in accordance with the terms of the application as approved herein and any approved plan, prepared by the applicant and endorsed by Council's Shire Planner.
3. The outbuilding shall not be used for human habitation, commercial or industrial purposes.

Advice Notes:

1. Nothing in the approval or these conditions shall excuse compliance with all relevant written laws in the commencement and carrying out of the development.
2. The applicant is advised a building permit is required prior to commencement of any building works.

CARRIED 8/0

Attachment 9.3



Attachment 9.3

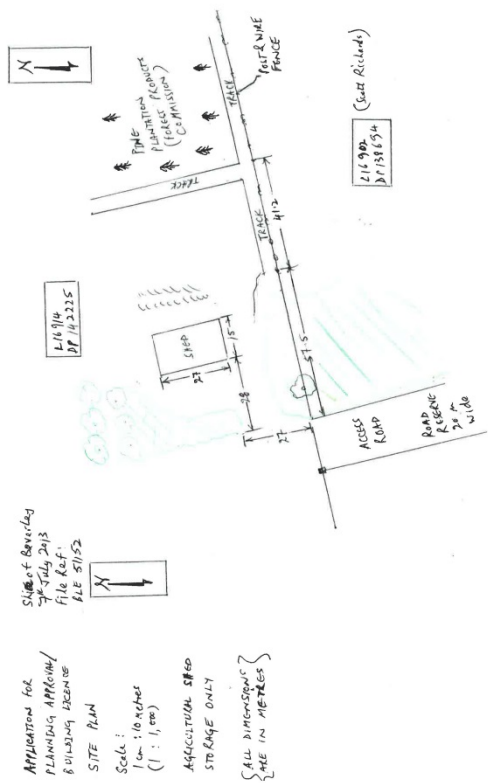
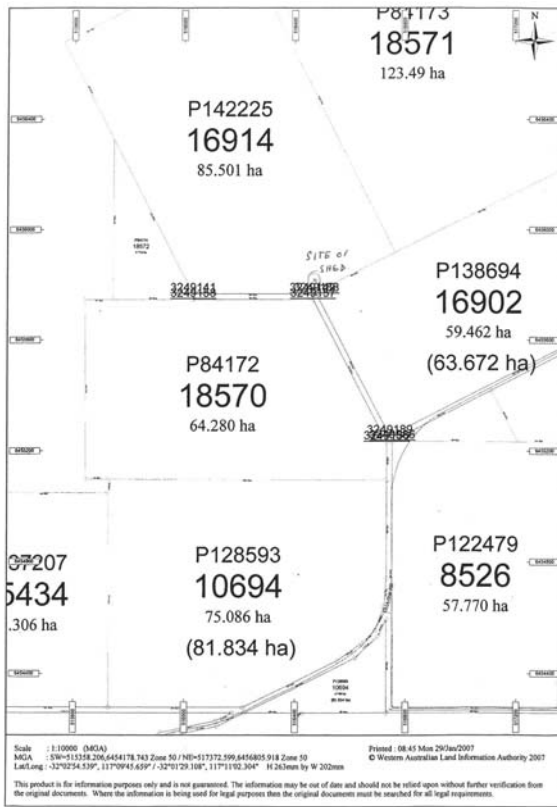

Attachment 9.3

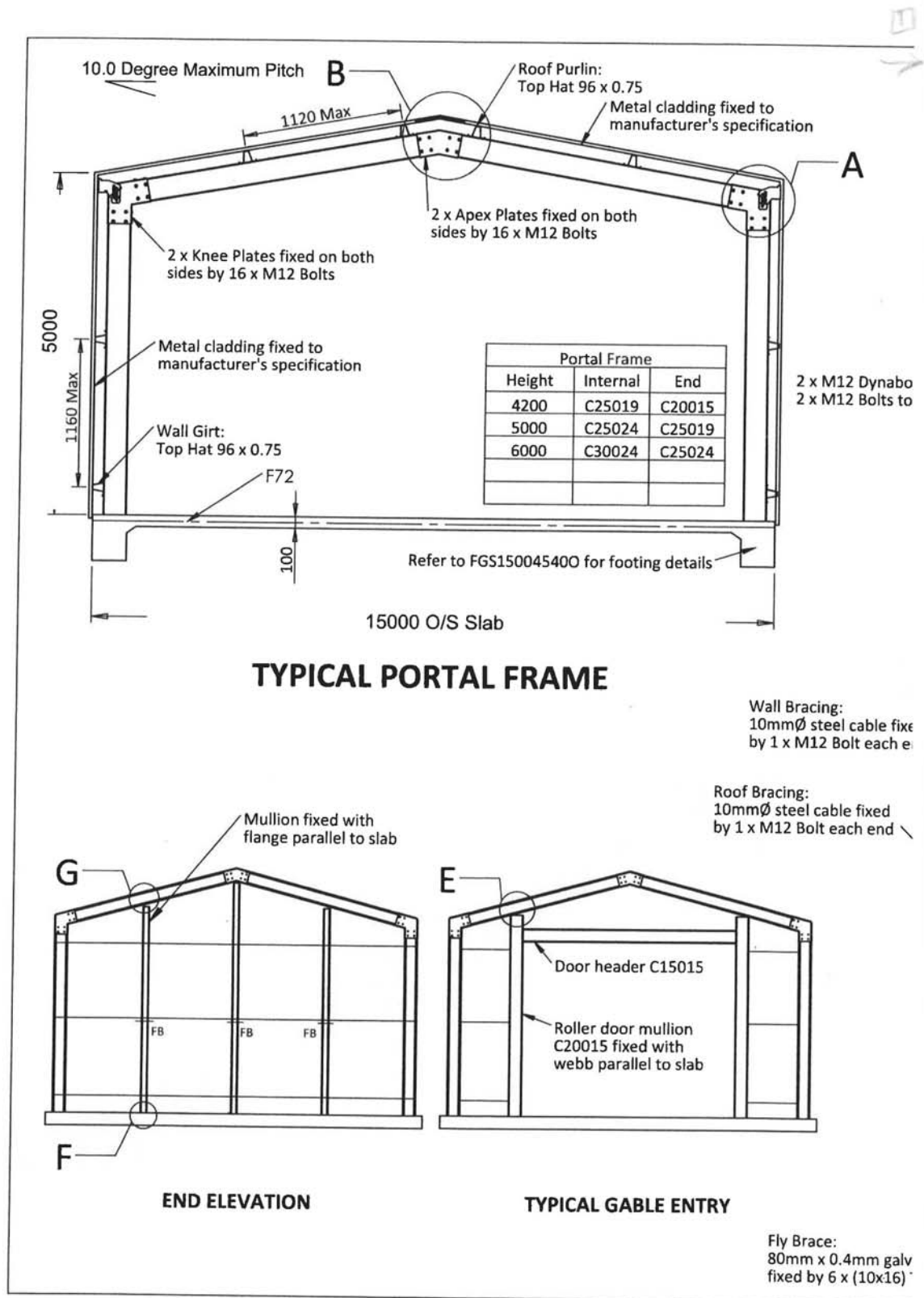

9.4 Application – Outbuilding (Garage) 23 (Lot 19) Hunt Road

SUBMISSION TO: Ordinary Council Meeting 24 September 2013
REPORT DATE: 17 September 2013
APPLICANT: Peter Jenkin
FILE REFERENCE: HUN 982
AUTHOR: B S de Beer, Shire Planner
ATTACHMENTS: Locality Map, Site Plan and Elevation Plan

SUMMARY

An application has been received to construct an Outbuilding (enclosed shed for cars and caravan), in extent 150m² at 23 (Lot 19) Hunt Road, Beverley. It will be recommended the application be approved.

BACKGROUND

In terms of the Shire's Outbuilding Policy, the maximum individual area of any Outbuilding in the Residential zone shall be 75m². The outbuilding is proposed to be 150m².

The subject site is located at no. 23 (Lot 19) Hunt Road, Beverley, is 2,023m² in extent and zoned Residential 10/25. It contains an existing dwelling and is functionally utilized as a unit with adjacent Lot 18.

COMMENT

When considering the proposed increased size of the development proposal beyond the parameters as set by the Outbuilding Policy, Shire Staff is of the opinion that the following aspects of the development should be taken into consideration:

- a) The specific siting of the Outbuilding on the property;
- b) The general character of the immediate area;
- c) The use of landscaping features to screen the development;
- d) The size of the subject property.

It is the opinion that the proposed siting of the Outbuilding at the subject property is such that it will not have any negative impact on the amenity of the surrounding area. The existing landscaping and the location of the dwelling unit will effectively screen the development so as to mitigate any negative impact that the proposed development might have. It is considered that the proposed development will be in pace with the character of the area.

Given the above site specific considerations and the substantial size of the property it is not anticipated that the granting of Planning Approval for this application will create an undesirable precedent.

CONSULTATION

No consultation was deemed required.

STATUTORY ENVIRONMENT

The application may be approved under the Shire of Beverley's Town Planning Scheme No. 2.

FINANCIAL IMPLICATIONS

Nil

STRATEGIC IMPLICATIONS

Nil

POLICY IMPLICATIONS

Nil

VOTING REQUIREMENT

Simple majority.

OFFICER'S RECOMMENDATION

That Council resolve to grant planning approval for an Outbuilding (Garage) at 23 (Lot 19) Hunt Road, Beverley, subject to the following conditions and advice notes:

Conditions:

1. If the development, the subject of this approval, is not SUBSTANTIALLY COMMENCED within a period of 2 years from the date of this approval being granted, the approval shall lapse and be of no further effect. Where an approval has lapsed, no development shall be carried out without the further approval of the responsible authority having first been sought and obtained.
2. Development shall be carried out only in accordance with the terms of the application as approved herein and any approved plan, prepared by the applicant and endorsed by Council's Shire Planner.
3. Cladding for the proposed development is to be Colorbond or similar approved material, in a colour which is in harmony with the area. Zinalume shall not be used for cladding.
4. The outbuilding shall not be used for human habitation, commercial or industrial purposes.

Advice Notes:

1. Nothing in the approval or these conditions shall excuse compliance with all relevant written laws in the commencement and carrying out of the development.
2. The applicant is advised a building permit is required prior to commencement of any building works.

COUNCIL RESOLUTION

M6/0913

Moved Cr Murray

Seconded Cr Gogol

That Council resolve to grant planning approval for an Outbuilding (Garage) at 23 (Lot 19) Hunt Road, Beverley, subject to the following conditions and advice notes:

Conditions:

- 1. If the development, the subject of this approval, is not SUBSTANTIALLY COMMENCED within a period of 2 years from the date of this approval being granted, the approval shall lapse and be of no further effect. Where an approval has lapsed, no development shall be carried out without the further approval of the responsible authority having first been sought and obtained.**
- 2. Development shall be carried out only in accordance with the terms of the application as approved herein and any approved plan, prepared by the applicant and endorsed by Council's Shire Planner.**
- 3. Cladding for the proposed development is to be Colorbond or similar approved material, in a colour which is in harmony with the area. Zinalume shall not be used for cladding.**
- 4. The outbuilding shall not be used for human habitation, commercial or industrial purposes.**

Advice Notes:

- 1. Nothing in the approval or these conditions shall excuse compliance with all relevant written laws in the commencement and carrying out of the development.**
- 2. The applicant is advised a building permit is required prior to commencement of any building works.**

CARRIED 8/0

9.5 Application – Special Event (Westdale Dirt Drags) Lot 83 Butchers Road

SUBMISSION TO: Ordinary Council 24 September 2013
REPORT DATE: 18 September 2013
APPLICANT: Wildcard Promotions
FILE REFERENCE: BUT 51004
AUTHOR: B S de Beer, Shire Planner
ATTACHMENTS: Event Overview

SUMMARY

An application for a special event on Lot 83 Butchers Road, Westdale – the Westdale Dirt Drags, had been received from Wildcard Promotions. The application will be recommended for approval.

BACKGROUND

It is proposed to conduct the Westdale Dirt Drags on 19 October 2013 at Lot 83 Butchers Road, Westdale. The subject site is approximately 49 ha in area, zoned Farming and contains existing buildings.

It is anticipated approximately 1,500 persons will attend the event. Similar events have taken place on the same subject property in the past.

COMMENT

Under the Shire of Beverley's Town Planning Scheme No. 2 (TPS 2) the proposed event is a *use not listed*. Clause 3.2.5 of TPS 2 states that where a land use is not listed Council may:

- a) *Determine that the use is not consistent with the objectives and purposes of the particular zone and is therefore not permitted; or*
- b) *Determine by absolute majority that the proposed use may be consistent with the objectives and purpose of the zone and thereafter follow the advertising procedures of Clause 6.2 in considering an application for planning consent, following which Council may, at its discretion, permit the use.*

In previous years the event has attracted a substantial number of tourists, members of the travelling public and residents of Beverley.

Given that the proposed use will not preclude agricultural use of the property for the remainder of the year and provides entertainment options not normally available in Beverley, it will be recommended Council determine that the proposed use may be consistent with the objectives and purpose of the Farming zone.

Advertising

In compliance with Clause 6.2 of TPS 2 the application was advertised for a period of 21 days. A total of 2 submissions were received comprising of 1 objection and 1 non objection. A summary of the submissions received and officer's responses are detailed in the table below:

	Respondent	Property	Comment	Planner's Response
1	Rob Fisher 305 Vallentine Road Beverley WA 6304	Lot 25880 Vallentine Road, Westdale	<ol style="list-style-type: none"> 1. Objection to the date of the event. 19 October too late regarding fire risk. See minutes of FCO meeting October 2012. 12 October is more appropriate. 2. Request Police presence, before, during and after event. 	<ol style="list-style-type: none"> 1. Please refer to the discussion below this table regarding this objection. 2. Although this is a police operational matter, Planning Officer emailed police (Sgt. Darrell Hagan), a copy of the application on 13 August 2013, for their records, and they confirmed their presence on the day.
2	W. Cherry 234 Holmes Road Forrestfield WA	Lot 84 Butchers Road Westdale	1. No Objection to Proposal.	Noted

Objection to development proposal

As mentioned in the table above, an objection to the holding of the event on the specific date had been received. The objection centres around the date of the proposed event being later than the date set at a Fire Control Officers (FCO) meeting, where it was decided that events of this nature should not take place at this venue after the second weekend of October each year, as a result of the potential fire risks that the event might pose. A copy of the minutes of the particular FCO meeting is attached hereto.

The above decision and the concerns raised were taken up with the applicant by the Shire Planner and a request was made to revise the Fire Management Plan in an effort to try and address the potential fire risk that might exist at this time of the year.

Applicant responded by providing reasons why it is not possible for the promoters to hold the event earlier in October, amongst others relating to similar events on the same date in the Eastern States requiring their involvement. Applicant also submitted the additional documents attached with this report, basically affirming their initial stance that they are suitably prepared should a fire event occur.

Legal advice had been sought through McLeods Solicitors as to the enforceability of the cut-off date for the event, from the Shire's perspective. The communication received is quoted herewith:

'I have reviewed the minutes of the Fire Control Officers (FCOs) meeting, which do not clarify whether there was any statutory basis for the determination made by the FCOs "That no events may be held after the second weekend in October that pose a fire risk".

*'FCOs or bush fire control officers are appointed by the local government under s. 39 of the Bush Fires Act 1954. Under s. 39 FCOs may exercise various special powers, which generally relate to the control and extinguishment of bushfires. The prevention of bushfires is dealt with under Part III of the Act. That Part authorises the declaration of restricted burning times or total fire bans by either the Minister or the FES Commissioner. Generally speaking, the restrictions contained in Part III relate to restrictions on lighting fires during periods of high fire danger as declared by the Minister or the FES Commissioner. **There are no restrictions under Part III that I am aware of, which are imposed on particular events or developments that may give rise to a bush fire risk.***

'I am also not aware of any general power exerciseable by a FCO under the Act, which authorises the FCO to declare that certain events, which do not in themselves involve burning or the lighting of fires, may only be held within stipulated periods. I am therefore not aware of any statutory basis for the resolution made by the FCOs at their meeting on 17 October 2012.

*'Consequently, I do not consider that the Shire would be precluded from granting planning approval to the proposed event. Nonetheless, any possible fire risk or hazard that may arise from the holding of the event would be a relevant planning consideration to which the Shire should have regard in exercising its discretion. I am not presently aware as to what zone the event is proposed to be held in, however I do note that it is an objective of the Farming Zone in cl. 3.5.1(f) to "prevent development in areas of extreme bushfire risk, and developments that may increase bushfire risk". If there is any potential bushfire risk that may arise from the holding of the event, this may be an issue that could be addressed by **suitably worded conditions** of approval. The Shire may also wish to refer to the WAPC's "Planning for Bushfire Protection", which sets out general principles for bush fire hazard risk management.'*

Taking due note of the role the Shire has in determining the abovementioned 'bushfire risk' (a valid planning concern), before determining the Development Application, a site visit was conducted by Shire Planner and Community Emergency Services Manager, Justin Corrigan, on 16 September 2013. The resultant report, in essence favourable to this specific event, is attached to this report.

The above report recommends that, should Council resolve to approve the application, an additional condition be added to further mitigate the fire risks, by providing additional fire breaks and re-grading of existing boundary fire breaks.

A further meeting regarding the matter took place on 18 September 2013 between Shire Staff and Fire Control Officers to discuss the way forward for applications similar in nature during similar times for future events.

Shire Planner mentioned at above meeting that it has to be noted that as a result of a number of weather related factors prevalent this year, the fire risks are anticipated to be of a lesser nature than would have normally been expected. This was affirmed during the site visit. It is assumed that in previous years the fire risks would have been greater as a result of drier seasons, and that this experience informed the decision by the FCO's in the first instance. It is accepted that the FCO's in deciding on the specific cut-off date for an event of this nature, is endeavouring to act

proactively in their approach towards Bushfire Management generally, and that this stance should be applauded.

Moving forward it is proposed that as a result of the above, as well as the legalities surrounding a possible refusal of an event of this nature, that each future development proposal continue to be assessed on its own specific merits, taking due cognisance of the potential for fire risks anticipated for that specific season/year. A meeting with the promoter will be arranged to discuss the viewpoint of the Shire and the FCO's in this regard.

General Merits

Similar events have occurred on this property previously. A search of Shire records indicates no correspondence regarding serious matters of concern has been received by the Shire.

The event will aid in economic development and economic diversification in the Shire of Beverley. Direct economic enhancement will occur due to catering for the needs of the substantial number of persons attending the event. Indirect economic benefit will come from raising the profile of Beverley throughout the state and making Beverley a tourist destination. As such the event will aid in economic diversification in Beverley.

Entertainment options in Beverley may be considered limited for the younger age groups. This event will provide an entertainment option comparable with those in the metropolitan area and not generally available in Beverley. As such the event will aid in enhancing the amenity of the Shire.

Fire Management

The proposal contains a fire management plan and an emergency evacuation plan to be implemented for the duration of the event. Should Council approve the application it will be recommended the fire management and emergency evacuation plans be implemented as conditions of approval.

First Aid and Management Plans

As components of the application, a fire risk, precaution and evacuation plan and a traffic management plan have been submitted. To cater for first aid at the previous events, an ambulance and three staff were on duty during the duration of the event. Shire staff, consider similar first aid arrangements should occur from 8:00am 19 October 2013 to 9:00pm 19 October 2013. Should Council approve the application, it will be recommended the fire and traffic management plans and first aid arrangements as detailed, be specified as conditions of approval.

Conclusion

The application to conduct the Westdale Dirt Drags at Lot 83 Butchers Road, Westdale is supported due to:

1. Diversification of economic activity;
2. Enhancement of amenity through provision of generally unavailable entertainment options;
3. Raising the profile of the Shire of Beverley;

4. Limited objections to the proposal; and
5. Economic benefit to the local economy.

It will therefore be recommended the proposal be considered a land use that is consistent with the objectives of the Farming zone and Council grant planning approval.

It is also submitted that the imposing of specific conditions should sufficiently address current concerns in relation to fire risks.

STATUTORY ENVIRONMENT

Subject to Council determination by absolute majority, as discussed above, the application may be considered consistent with the Shire of Beverley's Town Planning Scheme No. 2.

FINANCIAL IMPLICATIONS

Nil

STRATEGIC IMPLICATIONS

Nil

POLICY IMPLICATIONS

Nil

VOTING REQUIREMENTS

Absolute majority required.

OFFICER'S RECOMMENDATION

That Council resolve:

- a) By absolute majority that the proposed use is consistent with the planning objectives and purpose of the Farming zone.
- b) To grant planning approval for the Westdale Dirt Drags Special Event at Lot 83 Butchers Road, Westdale, subject to the following conditions and advice notes:

Conditions:

1. Planning approval for the event at Lot 83 Butchers Road, Westdale, is valid for the period of 19 October 2013 only.
2. Development shall be carried out only in accordance with the terms of the application as approved herein and any approved plan, prepared by the applicant and endorsed by Council's Shire Planner.
3. As the Water Corporation reticulated sewer is not available, acceptable ablution facilities are to be provided for the entire period of this approval.
4. The approved Fire Risk, Precautions and Emergency Evacuation Plan is to be complied with at all times, for the entire period of this approval.
5. Every All Terrain Vehicle used as part of the fire precautions, shall carry a fire extinguisher.

6. Prior to the event all boundary fire breaks shall be graded to a minimum width of 2.4 meters.
7. An internal fire break shall be placed around the main parking and spectator area as a buffer in the event a fire starts within this area.
8. The approved Traffic Management Plan is to be complied with at all times, for the entire period of this approval.
9. An ambulance and three staff qualified in first aid are to be available on-site between the hours of 8:00am 19 October 2013 to 9:00pm 19 October 2013.

Advice Notes:

1. Nothing in the approval or these conditions shall excuse compliance with all relevant written laws in the commencement and carrying out of the development.
2. The applicant is reminded that a permit might be required for the lighting of fires. Information can be obtained from FCO Robert Fisher, Dale Brigade, PH: 9647 2045
3. The applicant is advised that the Fire Control Officers at their meeting of 17 October 2012 resolved to recommend that no events that pose a fire risk may be held after the second weekend in October each year.

COUNCIL RESOLUTION

M7/0913

Moved Cr Gogol

Seconded Cr Alexander

That Council resolve:

- a) **By absolute majority that the proposed use is consistent with the planning objectives and purpose of the Farming zone.**
- b) **To grant planning approval for the Westdale Dirt Drags Special Event at Lot 83 Butchers Road, Westdale, subject to the following conditions and advice notes:**

Conditions:

1. **Planning approval for the event at Lot 83 Butchers Road, Westdale, is valid for the period of 19 October 2013 only.**
2. **Development shall be carried out only in accordance with the terms of the application as approved herein and any approved plan, prepared by the applicant and endorsed by Council's Shire Planner.**
3. **As the Water Corporation reticulated sewer is not available, acceptable ablution facilities are to be provided for the entire period of this approval.**
4. **The approved Fire Risk, Precautions and Emergency Evacuation Plan is to be complied with at all times, for the entire period of this approval.**
5. **Every All Terrain Vehicle used as part of the fire precautions, shall carry a fire extinguisher.**
6. **Prior to the event all boundary fire breaks shall be graded to a minimum width of 2.4 meters.**
7. **An internal fire break shall be placed around the main parking and spectator area as a buffer in the event a fire starts within this area.**
8. **The approved Traffic Management Plan is to be complied with at all times, for the entire period of this approval.**
9. **An ambulance and three staff qualified in first aid are to be available on-site between the hours of 8:00am 19 October 2013 to 9:00pm 19 October 2013.**

Advice Notes:

1. **Nothing in the approval or these conditions shall excuse compliance with all relevant written laws in the commencement and carrying out of the development.**
2. **The applicant is reminded that a permit might be required for the lighting of fires. Information can be obtained from FCO Robert Fisher, Dale Brigade, PH: 9647 2045**
3. **The applicant is advised that the Fire Control Officers at their meeting of 17 October 2012 resolved to recommend that no events that pose a fire risk may be held after the second weekend in October each year.**

CARRIED 8/0

Attachment 9.5

WESTDALE **DIRT DRAGS**

2013

EVENT OVERVIEW

Due to the strong interest within the “Off Road” sporting community and continued success of similar events throughout Australia, WILDCARD PROMOTIONS seeks the opportunity to stage WESTDALE DIRT DRAGS 2013.

WESTDALE DIRT DRAGS is a proposed Test & Tune event designed to allow local & interstate competitors, in all age brackets, the opportunity to demonstrate and/or tune their machines within this controlled, purpose built, ¼ mile venue. This venue has been designed to National Standards with state of the art electronic timing equipment and as such is the benchmark in Western Australia for this type of event. The proposal also includes a Burn-Out Competition within the stated area.

The proposed WESTDALE DIRT DRAGS is to be held on a portion of private land located at Lot 83 ‘Dale’ in the Shire of Beverly over the period of 19th of October 2013 between the hours of 9.00am to 7.00pm.

Organizers expect a patronage of around 1500 persons to attend the event.

Public parking and overnight camping areas have been provided.

Cool drinks and Water will be made available during the event.

Attachment 9.5

2

FIRE RISK

The expected fire risk at the time of the event is considered negligible, due to the good rainfall that the region has received, and the date of the event falls outside the 'Fire Ban' period. The area designated for use within the property boundaries consists of gently undulating pasture with small hills and ridges interspersed with smooth stone outcrops and boulders. There are few trees within the designated area, until it meets the rising eastern boundary which is lined with low scrub and gum.

FIRE PRECAUTIONS

WILDCARD PROMTIONS will designate approximately 6-8 event staff as 'Safety/Fire Marshalls' and they will be provided with two-way radios and have All Terrain Mobility.

Licensed Security Officers and Associated Personnel by Astute Security Services are on duty throughout the event and all will be designated 'Safety/Fire Marshalls'. They will be equipped with 2-way radios and distinctive clothing and will have attended a briefing prior to the event.

WILDCARD PROMOTIONS will establish a liaison with Emergency Services to enable correct and appropriate response to any critical incident.

Water from the dam and tank system will be utilized by the organiser by means of water pumps and mobile water carts (trucks).

A water tanker & delivery system will be on stand-by at the property in the event that it is required. However, in the likelihood of a major fire situation it is anticipated that an evacuation will be conducted and the incident to be handled by FESA/CFA.

Attachment 9.5

3

Any bulk fuel brought by competition entrants will be stored in a stand-alone area adjacent to the dirt drag pit area and access will be restricted.

Fire extinguishers will be located in strategic areas on the venue site – especially in areas of structure and high risk.

A site inspection will be conducted in the week preceding the event to re-evaluate any potential fire risk.

Professional & Volunteer St. Johns Ambulance First Aid Personnel will also be on-site to attend to any medical emergencies.

EMERGENCY EVACUATION

If any situation occurs that is deemed by the organizers to have the potential to threaten the safety of event staff and patrons a general evacuation of the site will be called. This will involve the use of the Public Address System to announce a General Evacuation and Fire Marshalls with loud- hailers to direct persons away from the point of any danger to the designated place of safety. In case of evacuation, the route will be mustered outside the main gate toward Butchers Road (west), as this route should be familiar to all persons who have entered the property – if necessary an alternative extra route may be accessed through the public parking area. Attempts to evacuate vehicles and possessions **WILL NOT BE PERMITTED** until such time that any potential danger has been deemed safe by attending Emergency Services.

The property is bounded by standard wire fencing and certain areas within the event will be fenced off. However these fences will be of low-level, light construction and are not considered a ‘containment’ threat in the case of evacuation.

Last year was considered a great success and all agencies worked well to achieve a safe and enjoyable event that is sure to be repeated.

**Prepared and compiled by ASTUTE SECURITY SERVICES on behalf of
WILDCARD PROMOTIONS (WA)**

Attachment 9.5

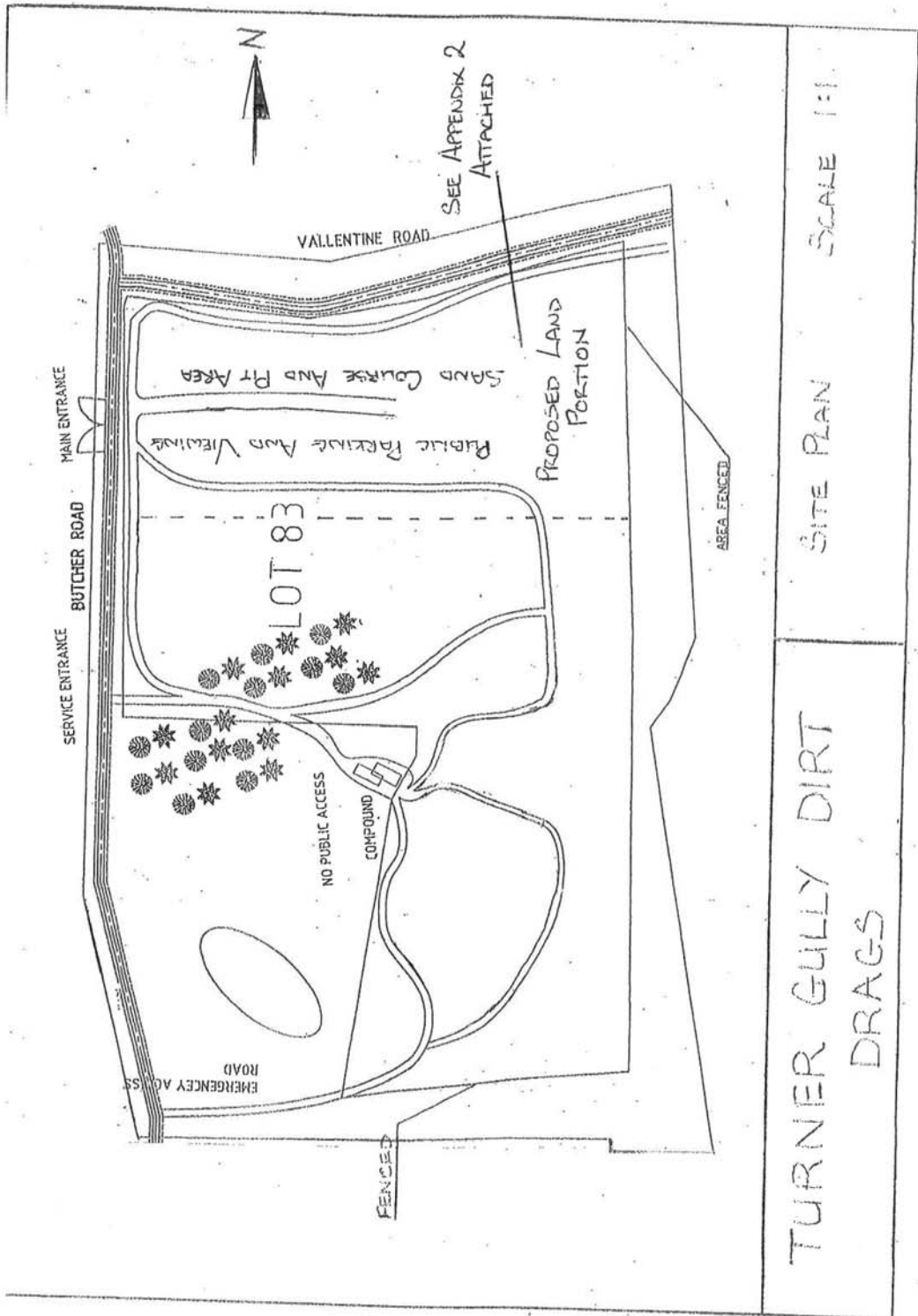

Attachment 9.5

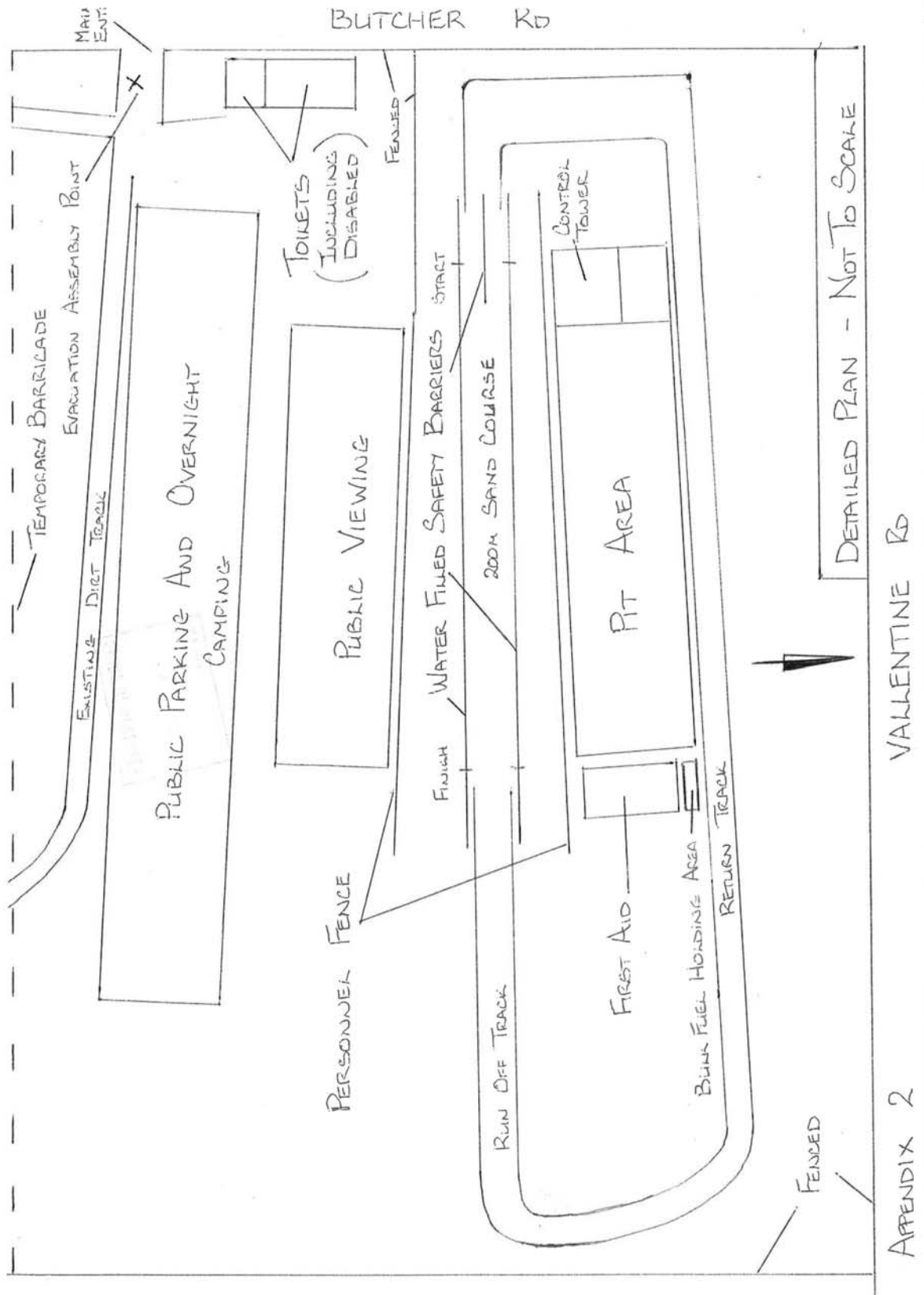

Attachment 9.5

AITE LINE TRAFFIC CONTROL P/L
ABN 20135175 085



MR PHIL UCHTMAI
63 Buckingham Roa
Kelmscott WA 611
M 0408 944 88
A/H 08 9390 627

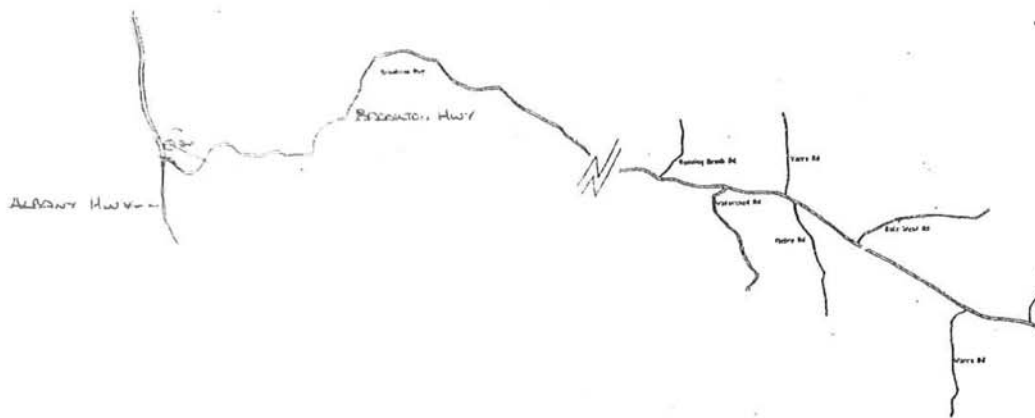

SIGNAGE TO BE PLACED AT CUC
* BROOKTON HWY & WESTDALE RD
* WESTDALE RD & BUTCHER RD

* 40 KM TEMPORARY SPEED SIGNS
TO BE PLACED AT 700M INTERVALS
ALONG BUTCHER RD

VMS #11
TRAFER GUL
DIRT DRAGS

Attachment 9.5

Dean Adams

August 25, 2013



Dear Stefan de Beer, {shire Planner},

In response to Respondent Mr. Rob Fishers comments regarding suggested date of event and potential fire risk associated with the activities of the annual Westdale Dirt Drags 19 October 2013.

This event held in previous years has raised no concern to council regarding serious matters. There have been no incidents or uncontrolled fires on the property during events.

We have implemented an effective and efficient Event Management plan to ensure all reasonable and practicable precautions are taken by the organizer/promoter to protect the safety and health of all patrons and the amenity of surrounding residents.

This Annual event proposed for on 19th October 2013 has been set with due consideration to all parties, potential risks and weather conditions that may arise. Organizers will liaise with the bureau of meteorology and Fesa prior to and on day of event to monitor local conditions or fire hazards and keep informed to be well prepared for any changes..

There has been no correspondence to myself or other organizers of this annual event suggesting that a specific date be set in the month of October. Matters discussed at an FCO meeting held on 27th October 2010 have not taken into account the factors of how a particular date is set for event.

Competitors from Eastern states have a certain schedule competing in different events around WA, are taken into account.

Ambulance and emergency personnel have been booked 3 months prior to event.

Advertising and organizing event to the best calendar date possible to make it a successful and viable event.

Comply with regulations and requirements of official parties.

To further improve the effectiveness of safety and regulations a large bore has been installed on the property which has the capability of filling

One 10,000lt water tanker in approximately five and a half minutes.

There will be three 10,000lt water tankers on site in the days before during and after the event continuously watering tracks, pits and patrons thoroughfare for both dust suppression and fire prevention.

All fuel for events is stored in a designated fenced off stand alone area adjacent to drag pit with access restricted to designated staff. A maximum of 10lt of fuel will be dispersed to competitors at any one time conveyed to the pit area.

Attachment 9.5

During our research at the bureau of meteorology website on average weather conditions in the shire of Beverley, we found the statistics that there is 75% chance of exceeding the median rainfall: August to October 2013, and typical weather conditions for October 19th around 25.4*c.

We will continuously observe weather conditions for the shire of Beverley prior to event.

Event management strive to keep the best practice and standards in relation to fire related risk and on two previous occasions after liaising with local fire officers prior to event have implemented a self imposed total fire ban on the entire property for the duration of the event due to dry and windy weather conditions.

Please find attached

Fire Risk Management Plan

Climate calendar for shire of Beverley,

DFES: Office of Bushfire Risk Management Charter.

With all due respect to parties involved please take into account the difficulty and extreme cost that that would arise from rescheduling this event at such late notice, due to unforeseen and uninformed decisions, and the fact that we have taken every precaution necessary to ensure the absolute safety and minimize risk to patrons and the surrounding community.

We understand our responsibilities in having an efficient and effective fire management plan and have ensured all conditions are completely adhered to.

Yours Sincerely,

Dean Adams
Director of Wildcard Promotions

Copyright © 1998 by Ann Poe

Attachment 9.5



"We Dig it"

Mr Phil Uchtman
63 Buckingham Rd
Kelmscott WA 6111
M 0408 944 887
A/H 9390 6271

To whom it may concern,

My name is Phillip Uchtman and I am the director of Uky' s Earthmoving.

I have been engaged by Wildcard Promotions to perform works at their block on Butchers rd, Westdale, for their upcoming event.

These works include prepaing the drag strip and upgrading roads and tracks on the block.

In addition to these works I have been asked to supply 3 water cart with experienced operators to water roads to suppress dust. They are to be equipped with large fan sprays for fire control.

I have also been asked to supply my 140 H Grader to cut double blade fire breaks around the entire property as well as around camp grounds and buildings.

I have been engaged to perform these works for the past 4 years at all these events. My operators and I all attend the event briefing and understand the concern with fire, but we go to great lengths to ensure we are fully prepared for an unlikely grass fire.

Regards,

Phillip Uchtman

Attachment 9.5

Climate calendar

<http://www.bom.gov.au/jsp/ncc/cdio/calendar/climate-calendar?stn...>



Climate calendar Beverley

The calendar is based on weather history and is not a forecast. Typical weather shows 7 day averages around this day of the year, while historical weather shows the conditions recorded for this day of the year.

Station: Beverley Number: 010515 Opened: 1886 Now: Open
Lat: 32.11°S Lon: 116.92°E Elevation: 199 m

Typical weather around 19 October

Averages	Days with rain					
			At least 2 mm	At least 5 mm	At least 10 mm	At least 25 mm
Maximum temperature	25.3 °C	Dry 0 mm				
Minimum temperature	8.3 °C					
Rainfall	0.7 mm	80 %	9 %	4 %	1 %	<1%

Historical weather on 19 October

	Maximum Temperature		Minimum Temperature		
Hottest day	34.8 °C	2004	Warmest night	15.0 °C	1971
Average	25.4 °C	45 y	Average	7.3 °C	45 y
Coldest day	18.3 °C	1971	Coldest night	1.1 °C	1973
Highest rainfall	8.8 mm	1991	On this day: In 2000, funnel clouds were observed in the Geelong area and at Cranbourne SE of Melbourne.		

Red text = data which are not quality controlled and confirmed. '-' = insufficient data.
These data may differ from the official quality checked records. This information is not a forecast.

Product Code: IDCJCC0012 reference: 13234623

COPYRIGHT

The copyright for any data is held in the Commonwealth of Australia and the purchaser shall give acknowledgement of the source in reference to the data. Apart from dealings under the copyright Act, 1968, the purchaser shall not reproduce, modify or supply (by sale or otherwise) these data without written permission. If you need more information, you can contact us via the Climate Data & Information links at: <http://www.bom.gov.au/inside/contacts.shtml>

LIABILITY

While every effort is made to supply the best data available this may not be possible in all cases. We do not give any warranty, nor accept any liability in relation to the information given, except that liability (if any), that is required by law.

Page created: Sun 25 Aug 2013 20:12:23 PM EST

This page was created at **18:12 on Sunday 25 August 2013 (AWST)**

© Copyright Commonwealth of Australia 2013, Bureau of Meteorology (ABN 92 637 533 532) | [Disclaimer](#) | [Privacy](#) | [Accessibility](#)

Attachment 9.5

Chance of exceeding the median Rainfall: August to October 2013
Product of the National Climate Centre

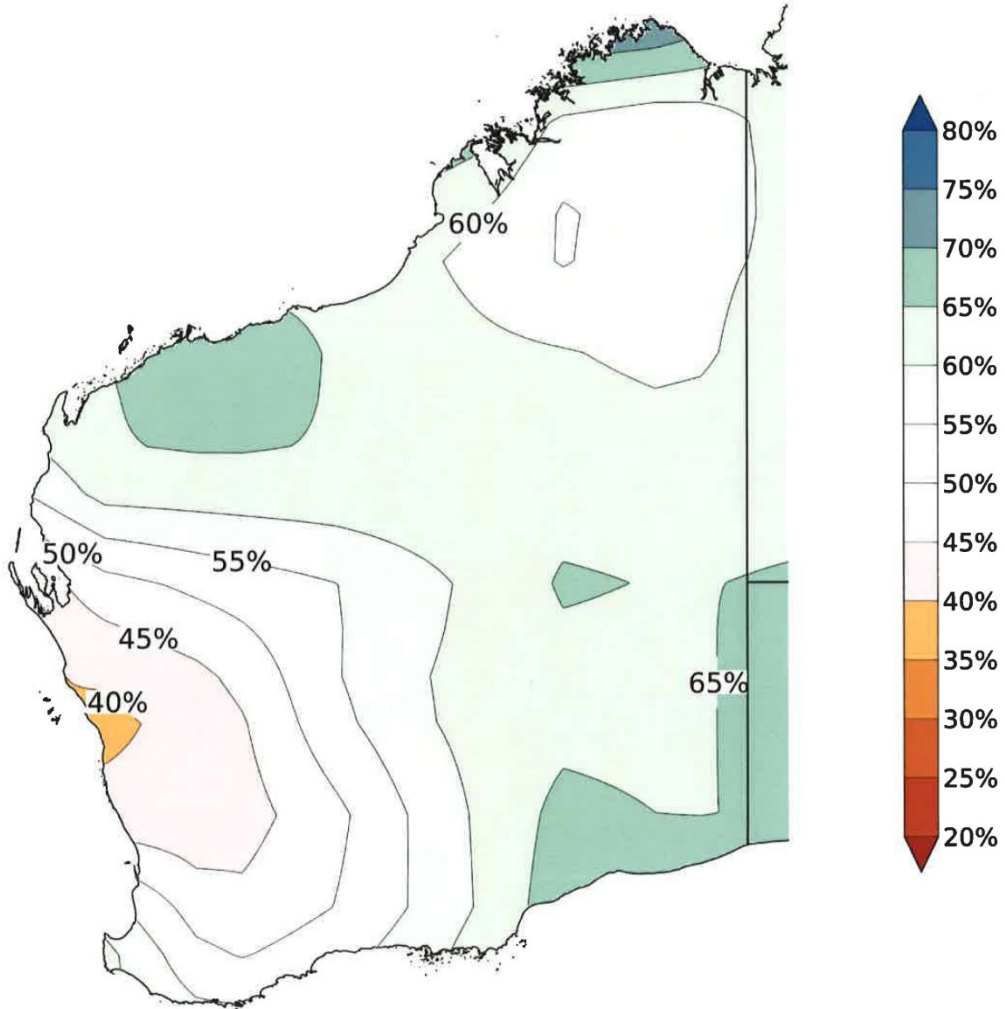

<http://www.bom.gov.au>
© Commonwealth of Australia 2013, Australian Bureau of Meteorology

Model Run: 15/07/2013
Issued: 22/07/2013

Attachment 9.5

everley, WA - Daily Weather Observations

<http://www.bom.gov.au/climate/dwo/IDCJDW6010.latest.shtml>



**Beverley, Western Australia
August 2013 Daily Weather Observations**

Most observations from a site in town.

Date	Temps			Rain	Evap	Sun	Max wind gust		9 am					3 pm					
	Min	Max	Max				Dir	Spd	Time	Temp	RH	Cld	Dir	Spd	MSLP	Temp	RH	Cld	Dir
Day	°C	°C	mm	mm	hours	km/h	local	°C	%	g ^h	km/h	hPa	°C	%	g ^h	km/h	hPa		
1	Th	6.0	20.4	0				11.0	97	6	Calm	1022.1	20.2	56	5	W	11	1021.5	
2	Fr	5.6	20.6	0.2				7.4	100	8	Calm	1028.6	19.8	54	2	Calm	1025.8		
3	Sa	4.4	19.4	0				8.0	97	2	Calm	1028.2	18.2	64	1	Calm	1023.7		
4	Su	5.0	22.2	0.2				7.0	97	8	Calm	1019.8	21.8	34	2	WSW	22	1023.7	
5	Mo	6.8	21.6	1.0				14.4	93	3	NNW	11	1016.2	21.0	46	3	W	37	1013.7
6	Tu	13.6	20.0	4.6				14.8	96	7	Calm	1017.0	19.8	76	7	NNW	11	1013.8	
7	We	14.4	22.8	1.6				16.6	90	5	NW	22	1015.0	22.2	60	5	NW	30	1011.7
8	Th	14.2	16.4	19.4				15.0	96	8	WSW	7	1011.5	15.4	75	5	WSW	15	1011.9
9	Fr	5.8	19.6	4.8				11.2	97	6	NNW	4	1019.4	19.2	60	5	NNW	11	1017.6
10	Sa	9.8	19.8	0				13.2	86	6	WNW	4	1018.5	17.4	71	6	W	22	1015.7
11	Su	8.2	18.4	0.4				12.0	93	6	WSW	4	1019.2	17.2	45	3	WSW	15	1018.1
12	Mo	7.6	18.2	0				11.2	90	8	NNW	11	1019.4	17.4	56	6	W	26	1017.7
13	Tu	10.2	18.8	0.2				13.6	82	5	WNW	4	1017.6	18.4	55	3	WSW	15	1015.9
14	We	3.0	17.8	0.4				5.8	97	3	Calm	1022.1	16.2	68	6	NW	11	1017.9	
15	Th	5.8	17.0	0.2				13.0	84	6	NW	7	1012.2	13.6	93	7	NW	11	1008.5
16	Fr	3.0	15.6	2.8				8.6	89	2	NW	4	1018.4	15.0	58	3	WSW	37	1016.7
17	Sa	3.6	18.6	1.2				10.8	97	1	WNW	7	1019.6	16.4	58	4	WSW	15	1019.1
18	Su	5.2	18.4	0				10.4	95	2	Calm	1024.2	17.6	51	5	Calm	1022.5		
19	Mo	5.0	19.8	0				10.8	90	4	Calm	1026.5	19.4	37	4	SW	7	1023.6	
20	Tu	3.2	19.6	0				6.8	100	8	Calm	1028.5	19.0	51	5	Calm	1025.5		
21	We	4.4	19.2	0				10.0	95	1	Calm	1030.2	18.2	52	4	SW	7	1027.2	
22	Th	3.6	18.6	0				10.4	90	1	Calm	1031.0	17.8	54	6	Calm	1028.0		
23	Fr	1.6	22.6	0				8.6	92	0	Calm	1027.2	22.2	38	0	NW	11	1022.9	
24	Sa	1.6	25.0	0				10.8	77	0	Calm	1019.7	24.0	33	1	N	11	1015.4	
25	Su	8.2		0				12.2	79	8	Calm	1012.5	18.6	54	8	NNW	15		

Statistics for the first 25 days of August 2013

Mean	6.4	19.6						10.9	91	4		3	1021.0	18.6	55	4		13	1019.1
Lowest	1.6	15.6	0					5.8	77	0	Calm	1011.5	13.6	33	0	Calm	1008.5		
Highest	14.4	25.0	19.4					16.6	100	8	NW	22	1031.0	24.0	93	8	#	37	1028.0
Total			37.0																

IDCJDW6010.201308 Prepared at 08:20 UTC on Sunday 25 August 2013

Source of data

Temperature, humidity, wind, cloud and rainfall observations are from Beverley (station 010515). Pressure observations are from York (station 010311).

The mean sea level pressure at York is provided for convenience. On most occasions it will be within 1 hPa of that at Beverley.

You should read the **important information** in [these notes](#).

Other formats

To print this page, get the [PDF version](#) (one page, 45 kb).

To use this page in a spreadsheet, get the [plain text version](#) (4 kb).

Other times and other places

The last 14 months of Daily Weather Observations for Beverley, Western Australia are also here on this web site:

[Aug 13](#) [Jul 13](#) [Jun 13](#) [May 13](#) [Apr 13](#) [Mar 13](#) [Feb 13](#) [Jan 13](#)
[Dec 12](#) [Nov 12](#) [Oct 12](#) [Sep 12](#) [Aug 12](#) [Jul 12](#)

Daily Weather Observations are also routinely prepared for hundreds of **other locations** in [Western Australia](#) and [across Australia](#). To get other months or places not on this web site, [contact us](#).

Climate statistics

If you are after **long-term averages** relevant to Beverley, Western Australia, look at the tables for [Beverley](#), [York Post Office](#) or [Brookton](#).

Maps and tables of average conditions for [locations across Australia](#) are also available.

More information

If you are using these pages, you are deemed to have understood the **important information** in [these notes](#). They cover how the data are obtained, how they are processed, and what each column means.

If you have **any questions** about this product, or you want any other weather or climate information, please [contact us](#).

This page was created at on

© Copyright Commonwealth of Australia, Bureau of Meteorology (ABN 92 637 533 532) | [Disclaimer](#) | [Privacy](#) | [Accessibility](#)

Attachment 9.5

ainfall Outlook

<http://www.bom.gov.au/watl/rainfall/exceedance.shtml?dataview=e...>



Rainfall Outlook: August-October

Rainfall outlooks for the coming season are derived from the Bureau's official seasonal climate outlook model. Consult the seasonal outlook verification information for areas of greatest skill.

Map or Table View

Outlook scenarios Chance of at least Table Above median outlook : [Report](#)

Chance of Exceeding

75 % 50 % 25 %



Rain Outlook: 75% chance of exceeding 1 August to 31 October 2013
Product of the National Climate Centre

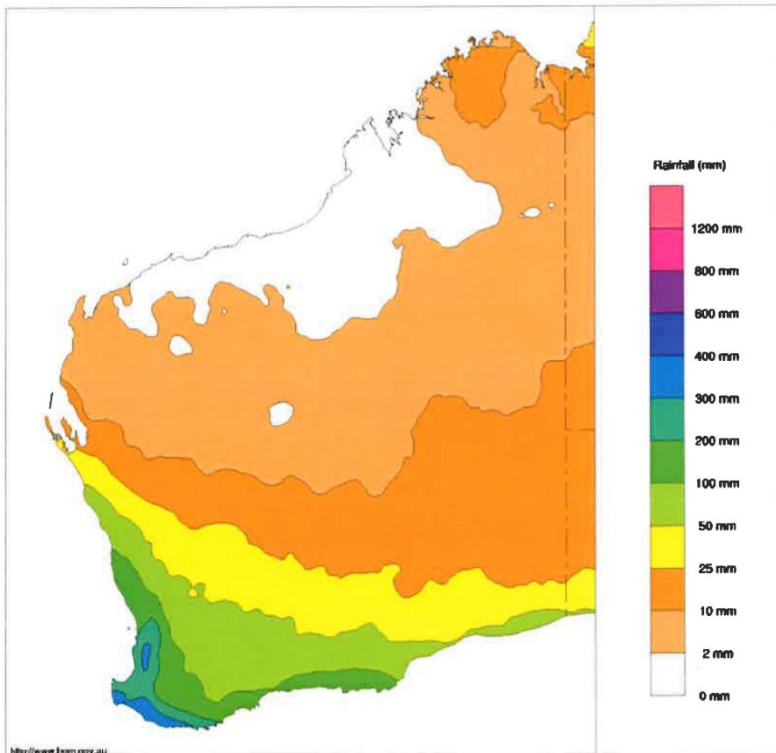

<http://www.bom.gov.au>
© Commonwealth of Australia 2013, Australian Bureau of Meteorology
Product Code: IDCKWSSR00

Issued: 18/07/2013

This page is produced with the support of [Managing Climate Variability](#) - a consortium of primary industry research and development corporations.

This page was created at on

© Copyright Commonwealth of Australia, Bureau of Meteorology (ABN 92 637 533 532) | [Disclaimer](#) | [Privacy](#) | [Accessibility](#)

Attachment 9.5

Climate statistics for Australian locations

http://www.bom.gov.au/climate/averages/tables/cw_010515.shtml



Climate statistics for Australian locations

Monthly climate statistics

Details of record

Location information
Name: BEVERLEY
Number: 010515
Latitude: 32.11 °S **Longitude:** 116.92 °E
Elevation: 199 m
Established: 1886 **Status:** Open
Latest available data: 21 Aug 2013

Additional information
 Additional site information

Nearest alternative sites
 J10311 YORK (27.5km)
 J10144 YORK POST OFFICE (29.4km)
 J10524 BROOKTON (30.3km)

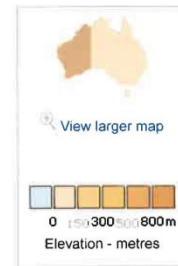

View: Main statistics All available |
 Period: Use all years of data

Statistics	Jan	Feb	Mar	Apr	May	Jun	Jul	Aug	Sep	Oct	Nov	Dec	Annual	Years
Temperature														
Mean maximum temperature (°C)	34.2	33.5	30.8	26.1	21.5	17.9	16.8	17.7	20.3	24.3	28.4	32.1	25.3	43 1968 2013
Mean minimum temperature (°C)	16.3	16.7	14.7	11.2	7.9	6.0	5.1	5.0	5.8	7.9	11.5	14.4	10.2	43 1968 2013
Rainfall														
Mean rainfall (mm)	11.9	13.3	16.4	22.9	53.7	78.6	77.4	58.5	36.1	23.6	15.3	10.4	418.4	128 1886 2013
Decile 5 (median) rainfall (mm)	2.2	3.7	7.5	18.2	50.9	75.2	70.2	56.4	34.9	19.4	10.0	4.2	409.3	109 1886 2013
Mean number of days of rain ≥ 1 mm	1.1	1.4	1.8	3.1	6.0	8.4	9.2	7.8	5.5	3.8	2.2	1.4	51.7	109 1886 2013
Other daily elements														
Mean daily sunshine (hours)														
Mean number of clear days	20.1	15.7	16.3	11.3	9.2	7.4	6.5	8.0	8.7	12.0	12.7	18.0	145.9	41 1968 2010
Mean number of cloudy days	3.7	4.6	5.4	8.0	11.1	12.0	12.5	10.8	9.8	7.5	6.4	3.7	95.5	41 1968 2010
9 am conditions														
Mean 9am temperature (°C)	23.3	22.7	20.7	17.1	12.8	9.9	9.1	10.0	12.5	16.4	19.8	22.3	16.4	41 1968 2010
Mean 9am relative humidity (%)	53	55	60	70	81	89	90	87	78	62	52	51	69	22 1970 2010
Mean 9am wind speed (km/h)	14.4	14.1	12.8	8.7	6.6	6.5	6.2	7.0	9.3	12.9	14.4	13.5	10.5	40 1968 2010
3 pm conditions														
Mean 3pm temperature (°C)	33.0	32.4	29.7	25.0	20.4	16.9	15.8	16.6	19.0	23.1	27.2	30.9	24.2	41 1968 2010
Mean 3pm relative humidity (%)	29	30	34	42	52	61	63	59	52	39	31	28	43	22 1970 2010
Mean 3pm wind speed (km/h)	13.5	13.8	13.0	11.2	11.5	11.8	12.6	13.2	14.1	14.3	15.2	13.8	13.2	40 1968 2010

red = highest value blue = lowest value

Product IDCJM0030 Prepared at Thu 22 Aug 2013 02:49:18 AM EST

Monthly statistics are only included if there are more than 10 years of data. The number of years (provided in the 2nd last column of the table) may differ between elements if the observing program at the site changed. More detailed data for individual sites can be obtained by contacting the Bureau.

Attachment 9.5

Shire of Beverley File Note

Officer: Justin Corrigan
Date: 16th September 2013
Subject: **Dirt Drags – Butchers Rd**

BACKGROUND

On 17th October 2012 at the Fire Control Officer meeting it was discussed and recommended that no events be held in the Shire of Beverley after the second weekend in October that pose a fire risk.

SITULATION

On Monday 16th September 2013 at 10am the Shire of Beverley Planner and I conducted a site visit to survey the potential fire risk the dirt drag event would pose by being held on third weekend in October.

From this site visit it appears that the amount of available fuel to burn is at a minimum, the available fuel are at a height of no more than 10 -15cm. Due to the timing and amount of rainfall over the past few weeks and the expected continuing rain fall the vegetation growth is green and not likely to carry a fire should one occur.

The property has a network of internal roadways that act as fire breaks throughout, they also have constructed fire breaks around the property boundaries.

The property also has a number of dams and sources located within short distances from existing structures and main drag runway that can use for fire fighting purposes

In the event of fire it is my understanding that the event has a number of fire marshals on mobile quick response vehicle and a large fire tender on site at all times

COMMENTS

It is of my opinion that holding the dirt drags on the 19th October would not pose a fire risk due to minimal fuel loads and high rainfall throughout September.

I would recommend to event organisers that prior to the event that all boundary fire breaks be graded to a minimum width of 2.4 metres and that an internal break be placed around the main parking and spectator area as a buffer in the event that a fire starts within this area.

Attachment 9.5

FIRE WEATHER OFFICERS

The meeting agreed that the Fire Weather Officers remain the same.

BRIGADE REPORTS:

Avondale: Nothing to report

Bally Bally: Nothing to report

Beverley Central: Nothing to report

Dale: Nothing to report

Dale West: Nothing to report

Kokeby: Nothing to report

Kokeby West: Nothing to report

Morbinning: Fire tender has been requested to attend fire outside the shire, Deane requested that the right procedures be followed when turning out.

North East: FCO Lincoln Murray advised the meeting that the brigade had received a grant for large transfer pump that could used at fires within the Shire

Talbot: Nothing to report

GENERAL BUSINESS:

HARVEST BANS – FCO's discussed the need for harvest bans to be placed on when fires occur within the Shire, it was decided that the first arriving FCO would make that decision.

The meeting also discussed and agreed that if resources (Fire units) are required to attend fires in other Shires then a harvest ban will be imposed.

DIRT DRAGS – Rob Fisher (FCO Dale) addressed the meeting with concerns for the timing each year of this event and other possible events within the Shire as they posse a fire risk if held to late in the year

Rob Fisher Moved **Seconded John Barrett-Lenard**
That no events may be held after the second weekend in October that posse a fire risk

WAERN RADIO – WAERN radio training for all FCO's will be held on Wednesday 24th October starting at 8.00am

SHIRE RESOURCES – David Adams (FCO Kokeby) requested that Shire resources (e.g. Water truck, grader and loader) be stored and available from the Shire depot on long weekend throughout fire season.

Justin Corrigan (CESM) advised meeting this would not be possible due to the Shires works program and these maybe stored in different location.

Attachment 9.5

CLOSURE:

There being no further business the meeting closed at 10:15pm.

I hereby certify these Minutes as being confirmed in accordance with Section 5.22 of the Local Government Act 1995.

Presiding Member

Date

2:20pm – Stefan de Beer and Dean Adams left the meeting and did not return.

10. BUILDING SERVICES & ENVIRONMENTAL HEALTH SERVICES

Nil

11. FINANCE

11.1 Monthly Financial Report

SUBMISSION TO: Ordinary Council Meeting 24 September 2013
REPORT DATE: 18 September 2013
APPLICANT: N/A
FILE REFERENCE: N/A
AUTHOR: S K Marshall, Deputy Chief Executive Officer
ATTACHMENTS: August 2013 Financial Reports

SUMMARY

Council to consider accepting the financial reports for the period ending 31 August 2013.

BACKGROUND

There is a statutory requirement that the Local Government is to prepare, each month, a statement of financial activity reporting on sources and applications of its funds and to present the statement to Council.

Council adopted a budget variance reporting parameter of 10% on budgeted items of \$10,000 or greater at the August 2013 Ordinary Meeting, Item 11.5

COMMENT

The monthly financial report for the period ending 31 August 2013 has been provided and includes:

- Financial Activity Statement;
- Statement of Net Current Assets;
- Statement of Financial Position; and
- Supplementary information, including;
 - Road Maintenance Report; and
 - Investment of Surplus Funds Report.

STATUTORY ENVIRONMENT

Section 6.4(1) of the *Local Government Act* provides that a local government is to prepare an annual financial report for the preceding financial year and such other financial reports as are prescribed.

Regulation 34 of the *Local Government (Financial Management) Regulations* requires a Statement of Financial Activity to be prepared each month which is to contain the following details:

- (a) annual budget estimates;
- (b) budget estimates to the end of the month;
- (c) actual amount of expenditure and revenue;
- (d) material variances between comparable amounts in (b) and (c) above; and
- (e) the net current assets at the end of the month to which the statement relates (i.e. surplus / (deficit) position).

The Statement is to be accompanied by:

- (a) explanation of the composition of net current assets, less committed assets and restricted assets;
- (b) explanation of the material variances; and
- (c) such other information considered relevant by the local government.

FINANCIAL IMPLICATIONS

All revenue and expenditure, unless disclosed in the notes to material variances, are as per the 2013/14 Budget.

STRATEGIC IMPLICATIONS

Nil

POLICY IMPLICATIONS

Investing Surplus Funds – That the Shire of Beverley only invests any surplus funds with the ANZ bank.

VOTING REQUIREMENTS

Simple majority

OFFICER'S RECOMMENDATION

That the monthly financial report for the month of August 2013 be accepted and material variances be noted.

COUNCIL RESOLUTION

M8/0913

Moved Cr Foster

Seconded Cr Gogol

That the monthly financial report for the month of August 2013 be accepted and material variances be noted.

CARRIED 8/0

**SHIRE OF BEVERLEY
FINANCIAL ACTIVITY STATEMENT
FOR THE PERIOD ENDED 31 AUGUST 2013**

	2013/14 ANNUAL BUDGET	2013/14 AUGUST BUDGET	2013/14 AUGUST ACTUAL	VARIANCE MONTH	2013/14 JULY- AUG BUDGET	2013/14 JULY- AUG ACTUAL	VARIANCE YTD	MATERIAL VARIANCES YTD
	\$	\$	\$	\$	\$	\$	\$	
OPERATING REVENUE								
General Purpose Funding	3,085,269	2,598,547	2,485,828	112,719	2,602,841	2,491,655	(111,186)	Financial Assistance Grants (GP & Roads) not yet received (\$129,184) and Rates discount not yet applied \$23,861.
Governance	88,200	14,112	0	14,112	17,640	44	(17,596)	CCTV Grant funding not yet received.
Law, Order Public Safety	448,142	6,735	41	6,694	6,991	30,059	23,068	ESL Operating Grant received \$10,983 and CESM Reimbursement received \$18,811.
Health	0	0	0	0	0	0	0	
Education and Welfare	4,500	320	0	320	400	620	220	
Housing	86,316	13,811	6,702	7,109	17,263	13,030	(4,233)	
Community Amenities	176,607	28,257	157,038	(128,781)	35,321	159,405	124,083	Refuse Charges (through Rates Issue) raised \$133,705.
Recreation and Culture	1,388,010	10,874	9,611	1,263	13,593	345,742	332,150	2012/13 CLGF funding received \$335,640.
Transport	736,332	8,200	3,729	4,471	10,250	7,364	(2,886)	
Economic Services	79,000	12,640	6,270	6,370	15,800	8,211	(7,589)	Blarney Advertising income (\$4,022) and Standpipe charges (\$1,604) less than anticipated YTD.
Other Property and Services	67,700	10,832	19,404	(8,572)	13,540	19,495	5,955	Private Works charges \$6,892 greater than anticipated YTD.
	6,160,076	2,704,327	2,688,623	15,704	2,733,639	3,075,624	341,985	
LESS OPERATING EXPENDITURE								
General Purpose Funding	(40,853)	(1,434)	(7,566)	6,132	(2,919)	(8,829)	(5,911)	Printing expense \$5,046 greater than anticipated.
Governance	(208,616)	(7,110)	(41,844)	34,734	(7,290)	(85,373)	(78,083)	Additional Sitting Fee payments (\$18,550), Subscription expense (\$25,998) and Salaries expense (\$36,484) greater than anticipated YTD.
Law, Order, Public Safety	(180,569)	(12,640)	(14,769)	2,129	(25,280)	(40,405)	(15,125)	Fire Prevention Insurance expense (\$13,747) greater than anticipated YTD.
Health	(86,605)	(6,062)	(6,184)	122	(12,125)	(18,504)	(6,380)	Child Health Centre maintenance expense (\$4,464) greater than anticipated YTD.
Education and Welfare	(52,246)	(3,657)	954	(4,611)	(7,314)	(4,851)	2,463	
Housing	(223,557)	(15,649)	(19,815)	4,166	(31,298)	(38,746)	(7,448)	
Community Amenities	(524,453)	(36,712)	(58,871)	22,159	(73,423)	(114,933)	(41,509)	Environmental Services expense (NRM fees 2012/13 - \$13,540), Planning Scheme expense (\$8,273) and other small variances greater than anticipated YTD.
Recreation and Culture	(1,223,740)	(85,662)	(105,959)	20,297	(171,324)	(215,524)	(44,201)	Rec Ground maintenance (\$24,604) and Reserve lease charges (\$11,700) greater than anticipated YTD.
Transport	(1,523,815)	(106,667)	(198,882)	92,215	(213,334)	(339,394)	(126,060)	Road maintenance expense (\$88,467), Depreciation expense (\$28,377) and Admin Allocation (\$6,830) greater than anticipated YTD.
Economic Services	(410,296)	(28,721)	(32,890)	4,169	(57,441)	(54,968)	2,474	
Other Property & Services	(37,380)	(19,931)	17,260	(37,191)	(19,913)	(52,173)	(32,260)	Plant Depreciation expense (\$20,020) and Admin Allocation (\$5,819) greater than anticipated YTD.
	(4,512,130)	(324,245)	(468,566)	144,321	(621,662)	(973,700)	(352,038)	
<i>Increase(Decrease)</i>	1,647,946	2,380,082	2,220,057	160,025	2,111,978	2,101,924	(10,053)	
-								

**SHIRE OF BEVERLEY
FINANCIAL ACTIVITY STATEMENT
FOR THE PERIOD ENDED 31 AUGUST 2013**

	2013/14 ANNUAL BUDGET	2013/14 AUGUST BUDGET MONTH	2013/14 AUGUST ACTUAL MONTH	VARIANCE MONTH	2013/14 JULY- AUG BUDGET YTD	2013/14 JULY- AUG ACTUAL YTD	VARIANCE YTD	MATERIAL VARIANCES YTD
	\$	\$	\$	\$	\$	\$		
ADD								
Principal Repayment Received -Loans	11,306	0	0	0	0	0	0	
Provision for Long Service Leave	0	0	0	0	0	0	0	
Profit/ Loss on the disposal of assets	(32,500)	0	0	0	0	0	0	
Depreciation Written Back	924,853	64,740	99,592	(34,852)	129,479	199,152	69,673	YTD Depreciation expense written back
Book Value of Assets Sold Written Back	279,500	0	0	0	0	0	0	
	1,183,159	64,740	99,592	(34,852)	129,479	199,152	69,673	
<i>Sub Total</i>	2,831,105	2,444,822	2,319,649	125,173	2,241,457	2,301,076	59,619	
LESS CAPITAL PROGRAMME							\$	
Purchase Tools	0	0	0	0	0	0	0	
Purchase Land & Buildings	(1,327,640)	0	(3,000)	3,000	0	(3,000)	(3,000)	
Infrastructure Assets - Roads	(2,352,462)	(164,672)	(7,272)	(157,400)	(376,394)	(7,622)	368,772	Road Construction program not yet commenced.
Infrastructure Assets - Recreation Facilities	(544,000)	0	15	(15)	0	(3,294)	(3,294)	
Infrastructure Assets - Other	(20,000)	0	0	0	0	0	0	
Purchase Plant and Equipment	(940,020)	0	(2,730)	2,730	0	(2,730)	(2,730)	
Purchase Furniture and Equipment	(105,000)	0	0	0	0	0	0	
Repayment of Debt - Loan Principal	(66,517)	0	0	0	0	0	0	
Transfer to Reserves	(126,081)	0	0	0	0	0	0	
	(5,481,720)	(164,672)	(12,987)	(151,685)	(376,394)	(16,645)	359,748	
ABNORMAL ITEMS								
Plus Rounding	0	0	0	0	0	0	0	
	(5,481,720)	(164,672)	(12,987)	(151,685)	(376,394)	(16,645)	359,748	
<i>Sub Total</i>	(2,650,615)	2,280,149	2,306,662	(26,513)	1,865,063	2,284,431	419,368	
LESS FUNDING FROM								
Reserves	400,000	0	0	0	0	0	0	
Loans Raised	0	0	0	0	0	0	0	
Closing Funds	2,250,615	0	(7,234)	7,234	2,250,615	2,243,381	7,234	
	2,650,615	0	(7,234)	7,234	2,250,615	2,243,381	7,234	
NET (SURPLUS) DEFICIT	0	2,280,149	2,299,428	(19,279)	4,115,678	4,527,812	426,602	

SHIRE OF BEVERLEY	
SUMMARY OF CURRENT ASSETS AND LIABILITIES	
FOR THE PERIOD ENDING 31 AUGUST 2013	
CURRENT ASSET	ACTUAL
Cash at Bank	
- Cash Advance	300.00
- Cash at Bank	3,485,110.77
- Investments Unrestricted	
- Investments Reserves	
Sundry Debtors General	2,978,466.25
Stock on Hand	13,036.38
Self-Supporting Loans	
GST	
Total Current Assets	6,476,913.40
LESS CURRENT LIABILITIES	ACTUAL
Sundry Creditors	258,025.89
Interest Bearing Loans and Borrowings	66,516.50
Provisions for Annual and Long Service Leave	303,601.47
Total Current Liabilities	628,143.86
Adjustments	
Less Cash Backed Reserves	(1,578,688.75)
Plus Interest Bearing Loans and Borrowings	66,516.50
Plus Annual Leave Cash Backed Reserves as at 30/06/2013	136,520.41
Plus LSL and Gratuity Cash Backed Reserves as at 30/06/2013	105,147.00
Less Deferred Pensioner Rates Non-Current as at 30/06/2013	(61,778.00)
Plus Reimbursement - Current Asset Portion of S/Supporting loan 117 2013-14	11,306.00
Total Adjustments	(1,320,976.84)
SURPLUS OF CURRENT ASSETS OVER CURRENT LIABILITIES	\$4,527,792.70

**SHIRE OF BEVERLEY
STATEMENT OF FINANCIAL POSITION
AS AT 31 AUGUST 2013**

Note: This section analyses the movements in assets, liabilities and equity between 2012/13 and 2013/14.	Actual 2012/13 \$	Actual 2013/14 \$	Variance \$
Current assets			
Cash and cash equivalents	3,607,179	3,485,411	(121,768)
Trade and other receivables	390,412	2,978,466	2,588,054
Inventories	11,478	13,036	1,558
Other assets	0	0	0
Total current assets	4,009,069	6,476,913	2,467,844
Non-current assets			
Trade and other receivables	172,447	121,976	(50,471)
Property, plant and equipment	10,953,357	10,861,776	(91,581)
Infrastructure	36,334,052	36,243,146	(90,906)
Total non-current assets	47,459,856	47,226,898	(232,958)
Total assets	51,468,925	53,703,811	2,234,886
Current liabilities			
Trade and other payables	125,065	258,026	(132,961)
Interest-bearing loans and borrowings	66,517	66,517	1
Provisions	303,601	303,601	(0)
Total current liabilities	495,183	628,144	(132,961)
Non-current liabilities			
Interest-bearing loans and borrowings	1,141,734	1,141,734	(0)
Provisions	36,619	36,620	(1)
Total non-current liabilities	1,178,353	1,178,354	(1)
Total liabilities	1,673,536	1,806,498	(132,962)
Net assets	49,795,389	51,897,313	2,101,924
Equity			
Accumulated surplus	44,737,607	44,737,827	220
Change in net assets resulting from operations	0	2,101,704	2,101,704
Asset revaluation reserve	3,479,093	3,479,093	0
Other reserves	1,578,689	1,578,689	(0)
Total equity	49,795,389	51,897,313	2,101,924

**SHIRE OF BEVERLEY
ROAD MAINTENANCE REPORT
FOR THE PERIOD ENDED 31 AUGUST 2013**

	M & C (Exp)	POC (Alloc)	PWOH (Alloc)	Wages (Alloc)	Total Alloc (Exp)	Total Exp
MISC						
MS7-Private Works - Stockpile Gravel	0.00	2,510.00	1,154.63	1,366.96	5,031.59	5,031.59
MS8-Main Street Banners	0.00	32.50	28.32	33.32	94.14	94.14
Total MISC	0.00	2,542.50	1,182.95	1,400.28	5,125.73	5,125.73
ROAD						
0001 MORBINING RD	0.00	4,880.00	2,199.25	2,598.70	9,677.95	9,677.95
0002 WATERHATCH RD	0.00	2,480.00	1,237.64	1,456.01	5,173.65	5,173.65
0003 YORK-WILLIAMS RD	0.00	3,922.50	1,387.76	1,641.24	6,951.50	6,951.50
0004 KOKEBY EAST RD	0.00	472.50	171.80	202.54	846.84	846.84
0005 EDISON MILL RD	0.00	1,500.00	455.82	536.26	2,492.08	2,492.08
0007 YENYENING LAKES RD	0.00	860.00	438.35	515.69	1,814.04	1,814.04
0009 BALLY-BALLY RD	0.00	2,332.50	724.45	856.36	3,913.31	3,913.31
0010 DALE KOKEBY RD	0.00	1,082.50	348.83	410.39	1,841.72	1,841.72
0011 KOKENDIN RD	0.00	3,432.50	1,278.36	1,537.78	6,248.64	6,248.64
0012 TALBOT WEST RD	0.00	885.00	561.35	660.41	2,106.76	2,106.76
0013 BARRINGTON RD	0.00	3,597.50	1,196.63	1,412.12	6,206.25	6,206.25
0014 POTTS RD	0.00	2,532.50	884.48	1,040.58	4,457.56	4,457.56
0015 JACOBS WELL RD	0.00	2,192.50	796.74	937.35	3,926.59	3,926.59
0016 CLULOWS RD	0.00	1,865.00	687.19	808.46	3,360.65	3,360.65
0017 OAKDALE RD	0.00	2,087.50	603.27	714.35	3,405.12	3,405.12
0018 DONGADILLING RD	0.00	3,315.00	1,041.05	1,230.22	5,586.27	5,586.27

**SHIRE OF BEVERLEY
ROAD MAINTENANCE REPORT
FOR THE PERIOD ENDED 31 AUGUST 2013**

	M & C (Exp)	POC (Alloc)	PWOH (Alloc)	Wages (Alloc)	Total Alloc (Exp)	Total Exp
0021 VALLENTINES RD	0.00	37.50	18.88	22.21	78.59	78.59
0022 LUPTONS RD	0.00	1,332.50	406.58	478.60	2,217.68	2,217.68
0023 SPRINGHILL RD	0.00	162.50	47.20	55.54	265.24	265.24
0024 DALEBIN NORTH RD	0.00	1,165.00	491.36	578.06	2,234.42	2,234.42
0025 BALLY-BALLY COUNTYPEAK RD	0.00	97.50	35.96	42.30	175.76	175.76
0026 ATHOL RD	0.00	1,170.00	451.94	533.66	2,155.60	2,155.60
0027 EWERTS RD	0.00	1,235.00	379.54	448.91	2,063.45	2,063.45
0028 NORTHBOURNE RD	0.00	762.50	245.46	288.78	1,296.74	1,296.74
0029 BERINGER RD	0.00	2,092.50	663.20	783.88	3,539.58	3,539.58
0030 GORS RD	0.00	1,982.50	533.97	631.15	3,147.62	3,147.62
0032 BALKULING RD	0.00	2,940.00	979.44	1,152.99	5,072.43	5,072.43
0033 GLENCOE RD	0.00	4,137.50	1,332.86	1,577.99	7,048.35	7,048.35
0034 ST JACKS RD	0.00	452.50	138.97	163.78	755.25	755.25
0035 RICKEYS RD	0.00	907.50	324.33	382.40	1,614.23	1,614.23
0036 GREENHILLS SOUTH RD	0.00	315.00	290.00	341.17	946.17	946.17
0038 PETCHELLS RD	0.00	0.00	307.62	361.91	669.53	669.53
0040 HOBBS RD	0.00	472.50	196.83	231.56	900.89	900.89
0041 SOUTHERN BRANCH RD	0.00	425.00	122.73	144.39	692.12	692.12
0043 CORBERDING RD	0.00	500.00	179.37	211.04	890.41	890.41
0046 BLACKBURN RD	0.00	300.00	75.53	88.86	464.39	464.39
0052 EAST LYNNE RD	0.00	472.50	146.50	172.91	791.91	791.91
0054 McDONALDS RD	0.00	1,670.00	480.85	567.38	2,718.23	2,718.23
0055 KIEARA RD	0.00	495.00	174.44	225.23	894.67	894.67

**SHIRE OF BEVERLEY
ROAD MAINTENANCE REPORT
FOR THE PERIOD ENDED 31 AUGUST 2013**

	M & C (Exp)	POC (Alloc)	PWOH (Alloc)	Wages (Alloc)	Total Alloc (Exp)	Total Exp
0056 RIFLE RANGE RD	0.00	662.50	189.11	223.60	1,075.21	1,075.21
0060 BATYS RD	0.00	550.00	182.46	214.65	947.11	947.11
0064 FERGUSONS RD	0.00	437.50	120.06	141.25	698.81	698.81
0068 WOODS RD	0.00	187.50	47.20	55.54	290.24	290.24
0070 PICCADILLY RD	0.00	262.50	84.62	99.54	446.66	446.66
0071 MURRAYS RD	0.00	860.00	275.68	324.31	1,459.99	1,459.99
0072 SMITH RD	0.00	300.00	84.97	99.96	484.93	484.93
0073 JOHNSONS RD	0.00	67.50	27.97	32.90	128.37	128.37
0076 HILLS RD	0.00	300.00	75.53	88.86	464.39	464.39
0078 BATEMANS RD	0.00	420.00	112.22	132.44	664.66	664.66
0079 DRAPERS RD	0.00	1,285.00	478.11	562.48	2,325.59	2,325.59
0080 MILLS RD	0.00	125.00	37.76	44.43	207.19	207.19
0095 HEALS RD	0.00	225.00	71.92	84.61	381.53	381.53
0098 AVOCA RD	0.00	355.00	195.76	230.31	781.07	781.07
0100 MAWSON RD	0.00	90.00	118.78	139.73	348.51	348.51
0101 SIMMONS RD	0.00	12.50	44.94	52.88	110.32	110.32
0102 DOBADERRY RD	0.00	150.00	46.18	54.33	250.51	250.51
0103 FORREST ST	0.00	412.50	738.99	869.39	2,020.88	2,020.88
0104 LUKIN ST	0.00	250.00	202.52	238.27	690.79	690.79
0105 JOHN ST	0.00	88.75	262.00	308.25	659.00	659.00
0106 DAWSON ST	0.00	90.00	36.47	42.90	169.37	169.37
0108 SMITH ST	0.00	112.50	74.56	87.72	274.78	274.78
0109 HARPER ST	0.00	137.50	121.57	143.03	402.10	402.10

**SHIRE OF BEVERLEY
ROAD MAINTENANCE REPORT
FOR THE PERIOD ENDED 31 AUGUST 2013**

	M & C (Exp)	POC (Alloc)	PWOH (Alloc)	Wages (Alloc)	Total Alloc (Exp)	Total Exp
0110 QUEEN ST	0.00	45.00	36.21	42.60	123.81	123.81
0111 DEMPSTER ST	0.00	1,276.25	807.53	950.05	3,033.83	3,033.83
0115 HOPE ST	0.00	112.50	121.19	142.58	376.27	376.27
0122 BROOKING ST	0.00	145.00	65.61	77.19	287.80	287.80
0123 NICHOLAS ST	0.00	615.00	225.16	264.90	1,105.06	1,105.06
0124 RICHARDSON ST	0.00	590.00	256.28	301.51	1,147.79	1,147.79
0125 VINCENT ST	0.00	913.75	605.92	712.87	2,232.54	2,232.54
0131 ELIZABETH ST	0.00	270.00	139.82	164.50	574.32	574.32
0135 ERNEST DR	0.00	90.00	74.56	87.72	252.28	252.28
0137 RICKEYS SIDING RD	0.00	1,462.50	525.63	619.66	2,607.79	2,607.79
0143 LUDGATE ST	0.00	150.00	37.76	44.43	232.19	232.19
0147 RAILWAY PDE	0.00	75.00	23.97	28.20	127.17	127.17
0149 COUNCIL RD	0.00	45.00	36.21	42.60	123.81	123.81
0154 WYALGIMA RD	0.00	112.50	28.32	33.32	174.14	174.14
0160 DUFFIELD ST	0.00	150.00	47.95	56.41	254.36	254.36
0166 WESTDALE RD	3,026.86	2,115.00	2,231.48	2,679.86	7,026.34	10,053.20
0180 LITTLE HILL RD	0.00	137.50	47.20	55.54	240.24	240.24
5001 HUNT RD	0.00	377.50	205.08	241.27	823.85	823.85
8888 TREE LOPPING	0.00	2,367.50	4,012.04	4,727.76	11,107.30	11,107.30
9999 ROADS VARIOUS	11,313.00	3,941.25	3,274.99	3,852.97	11,069.21	22,382.21
Total ROAD	14,339.86	82,935.00	38,468.82	45,440.48	166,844.30	181,184.16
TOTAL	14,339.86	85,477.50	39,651.77	46,840.76	171,970.03	186,309.89

SHIRE OF BEVERLEY INVESTMENT OF SURPLUS FUNDS AS AT 31 AUGUST 2013						
Account #	Account Name	Amount Invested (\$)	Total	Term	Interest Rate	Maturation
9701-42341	Reserve Funds					
	Long Service Leave	105,147.02				
	Plant	79,169.45				
	Bush Fire Fighters	105,974.40				
	Building	325,542.22				
	Recreation Ground	320,749.00				
	Cropping Committee	221,697.66				
	Avon River Development	21,300.22				
	Annual Leave	136,520.41				
	Community Bus	31,916.46				
	Road Construction	230,671.91	1,578,688.75	94 days	4.20%	30/09/2013
2092-96973	Online Saver	823,906.58	823,906.58	Ongoing	2.25%	
9709-83757	Term Deposit	1,004,315.06	1,004,315.06	94 days	4.20%	30/09/2013
	Total		3,406,910.39			

11.2 Accounts Paid by Authority

SUBMISSION TO: Ordinary Council Meeting 24 September 2013
REPORT DATE: 17 September 2013
APPLICANT: N/A
FILE REFERENCE: N/A
AUTHOR: S K Marshall, Deputy Chief Executive Officer
ATTACHMENTS: August 2013 – List of Accounts

SUMMARY

Council to consider authorising the payment of accounts.

BACKGROUND

The following list represents accounts paid by authority for the month of August 2013.

COMMENT

Unless otherwise identified, all payments have been made in accordance with Council's 2013/14 Budget.

STATUTORY ENVIRONMENT

Regulation 12 of the Local Government (Financial Management) Regulations provides that:

- (1) A payment may only be made from the municipal fund or the trust fund —
 - (a) if the local government has delegated to the CEO the exercise of its power to make payments from those funds — by the CEO; or
 - (b) otherwise, if the payment is authorised in advance by a resolution of the council.
- (2) The council must not authorise a payment from those funds until a list prepared under regulation 13(2) containing details of the accounts to be paid has been presented to the council.

Regulation 13 of the Local Government (Financial Management) Regulations provides that:

- (1) If the local government has delegated to the CEO the exercise of its power to make payments from the municipal fund or the trust fund, a list of accounts paid by the CEO is to be prepared each month showing for each account paid since the last such list was prepared —
 - (a) the payee's name;
 - (b) the amount of the payment;
 - (c) the date of the payment; and
 - (d) sufficient information to identify the transaction.
 - (2) A list of accounts for approval to be paid is to be prepared each month showing —
 - (a) for each account which requires council authorisation in that month —
 - (i) the payee's name;
 - (ii) the amount of the payment; and
 - (iii) sufficient information to identify the transaction;
- and
- (b) the date of the meeting of the Council to which the list is to be presented.

(3) A list prepared under sub regulation (1) or (2) is to be —

- (a) presented to the Council at the next ordinary meeting of the council after the list is prepared; and
- (b) recorded in the minutes of that meeting.

FINANCIAL IMPLICATIONS

Unless otherwise identified, all payments have been made in accordance with Council's 2012/13 Budget.

STRATEGIC IMPLICATIONS

Nil

POLICY IMPLICATIONS

Authority to Purchase – All acquisitions should be in accordance with budget provisions or to a maximum specified cost.

VOTING REQUIREMENTS

Simple majority

OFFICER'S RECOMMENDATION

That the List of Accounts as presented:

August 2013:

- (1) **Municipal Fund** – Account 016-540 239 838 056
 - Cheque vouchers: 1086-1098 incl totalling \$ 56,041.19 previously paid
 - EFT vouchers 01 August 13 01–39 incl totalling \$ 46,789.38
 - EFT vouchers 09 August 13 01–70 incl totalling \$ 306,900.88
 - EFT vouchers 15 August 13 01–38 incl totalling \$ 46,746.39
 - EFT vouchers 19 August 13 01–16 incl totalling \$ 8,731.15
 - EFT vouchers 27 August 13 01–03 incl totalling \$ 16,033.16
 - EFT vouchers 29 August 13 01–40 incl totalling \$ 47,737.27
 - \$ 472,938.23 previously paid
- (2) **Trust Fund** – Account 016-239 838 123
 - EFT vouchers 09 August 13 01-05 incl totalling \$ 150.00 previously paid
- (3) **Direct Debit** Payments totalling \$ 60,080.46 previously paid
- (4) **Credit Card** Payments totalling \$ 3,654.50 previously paid

be received

COUNCIL RESOLUTION

M9/0913

Moved Cr Foster

Seconded Cr Gogol

That the List of Accounts as presented:

August 2013:

(1) Municipal Fund – Account 016-540 239 838 056		
Cheque vouchers: 1086-1098 incl totalling	\$ 56,041.19	previously paid
EFT vouchers 01 August 13 01–39 incl totalling	\$ 46,789.38	
EFT vouchers 09 August 13 01–70 incl totalling	\$ 306,900.88	
EFT vouchers 15 August 13 01–38 incl totalling	\$ 46,746.39	
EFT vouchers 19 August 13 01–16 incl totalling	\$ 8,731.15	
EFT vouchers 27 August 13 01–03 incl totalling	\$ 16,033.16	
EFT vouchers 29 August 13 01–40 incl totalling	\$ 47,737.27	
	\$ 472,938.23	previously paid
(2) Trust Fund – Account 016-239 838 123		
EFT vouchers 09 August 13 01-05 incl totalling	\$ 150.00	previously paid
(3) Direct Debit Payments totalling	\$ 60,080.46	previously paid
(4) Credit Card Payments totalling	\$ 3,654.50	previously paid
be received		

CARRIED 8/0

TYPE	DATE	PAYEE	DETAILS	AMT PAID	TOTALS
Liability Chq	01/08/2013	AUST SUPER	SUPER CONTRIB: FE 30 JUL 13	0.00	0.00
Liability Chq	01/08/2013	BT FIN GP-LEONHARDT Scott	SUPER CONTRIB: FE 30 JUL 13	0.00	0.00
Liability Chq	01/08/2013	COLONIAL FIRST STATE-CORRIGAN Justin	SUPER CONTRIB: FE 30 JUL 13	0.00	0.00
Liability Chq	01/08/2013	COLONIAL FIRST STATE-MOULTON Clare	SUPER CONTRIB: FE 30 JUL 13	0.00	0.00
Liability Chq	01/08/2013	CSRF - CATHOLIC SUPER & RETIREMENT FUND	SUPER CONTRIB: FE 30 JUL 13	0.00	0.00
Liability Chq	01/08/2013	DOMINION SUPERANNUATION MASTER TRUST	SUPER CONTRIB: FE 30 JUL 13	0.00	0.00
Liability Chq	01/08/2013	KINETIC SUPER (ACCTS SUPER)	SUPER CONTRIB: FE 30 JUL 13	0.00	0.00
Liability Chq	01/08/2013	SHIRE OF BEVERLEY	2013-07 JUL SAL DEDUCTIONS (30 JUL): RATES	0.00	0.00
Liability Chq	01/08/2013	SUPERWRAP - PERSONAL SUPER PLAN	SUPER CONTRIB: FE 30 JUL 13	0.00	0.00
Liability Chq	01/08/2013	WALGSP - SUPER	SUPER CONTRIB: FE 30 JUL 13	0.00	0.00
Direct Debit	01/08/2013	CBA - MERCHANT BANKING	JUL 2013 TRANSACTION FEES	-111.66	-111.66
Direct Debit	05/08/2013	CBA - MERCHANT BANKING	JUL 2013 ACCCESS FEE	-38.60	-38.60
Direct Debit	05/08/2013	ANZ- TRANSACTIVE (ONLINE BANKING)	JUL 13 ONLINE BANKING	-70.00	-70.00
Direct Debit	05/08/2013	WESTNET PTY LTD	AUG 2013 INTERNET ACCESS	-66.00	-66.00
EFT Pymt	09/08/2013	ADC PROJECTS	ADMIN BLDG: CONCEPT PLANS	-6,404.75	
EFT Pymt	09/08/2013	ADV BUILDING ENGINEERS P/L	INFANT HEALTH BLDG: REPAIR WORSK & SITE INSPECTION REPORTS	-3,960.00	
EFT Pymt	09/08/2013	AG IMPLEMENTS NORTHAM/MERREDIN	BE30 (BH02): PARTS	-449.96	
EFT Pymt	09/08/2013	ALLIANCE FIRE PROTECTION	BI ANNUAL FIRE EXTINGUISHER MAINTENANCE	-2,420.00	
EFT Pymt	09/08/2013	AMPAC	2013-07 JUL RATES DEBT RECOVERY	-82.50	
EFT Pymt	09/08/2013	ARCHIVEWISE	2013-07 JUL STORAGE of ARCHIVES: 95 BOXES	-40.74	
EFT Pymt	09/08/2013	ARROW BRONZE	PLAQUE for the LATE STEWART & MARY SHAW	-524.81	

TYPE	DATE	PAYEE	DETAILS	AMT PAID	TOTALS
EFT Pymt	09/08/2013	AUSSIE IT	PRINTER INK - VARIOUS	-143.32	
EFT Pymt	09/08/2013	AUST POST	JUL 13 POSTAGE	-268.30	
EFT Pymt	09/08/2013	AVON EXPRESS - STANFIELD Cobb	FREIGHT CHARGES: JUN 13	-88.00	
EFT Pymt	09/08/2013	AVON WASTE	3,822 BIN COLLECTION ME 26 JUL 13 INC RECYCLING BINS & 1 x RECYCLING COLLECTIO	-8,529.98	
EFT Pymt	09/08/2013	BDH - BEV DOME HIRE	DIESEL: 4,001 L; ULP 2,004 L	-8,910.69	
EFT Pymt	09/08/2013	BEV AG SOCIETY	2013 TROPHY SPONSORSHIP	-150.00	
EFT Pymt	09/08/2013	BEV BAKERY	UWA "BEVERLEY DESIGN STUDIO": REFRESHMENTS - 03 AUG 13	-47.50	
EFT Pymt	09/08/2013	BEV COUNTRY KITCHEN	VARIOUS MEETINGS: 10, 11, 19 JUL 2013	-516.00	
EFT Pymt	09/08/2013	BEV FARM SERVICES	NOXIOUS WEEDS - TOWN & RURAL: CHEMICALS	-3,067.84	
EFT Pymt	09/08/2013	BEV GAS & PLUMBING	VARIOUS LOCATIONS	-3,847.78	
EFT Pymt	09/08/2013	BEV NEWS - Barry & Pauline	JUL 2013 ACCOUNT	-119.35	
EFT Pymt	09/08/2013	BLACKTOP CONSULTING ENGINEERS	INFANT HEALTH & CRC BLDGS: GEOTECHNICAL INVESTIGATIONS	-6,600.00	
EFT Pymt	09/08/2013	BLECHY'S TYRE & BATTERY	JUN & JUL 13 - TYRE MAINTENANCE	-3,220.00	
EFT Pymt	09/08/2013	BOC LIMITED	JUL 13: CYLINDER RENTAL & AGROSHIELD	-158.34	
EFT Pymt	09/08/2013	BOULTON Kim	RECORD MANAGEMENT ASSISTANCE	-2,329.25	
EFT Pymt	09/08/2013	BT FIN GP-LEONHARDT Scott	SUPER CONTRIB: FE 30 JUL 13	-166.86	
EFT Pymt	09/08/2013	BUNNINGS BUILDING SUPPLIES P/L	HARDWARE SUPPLIES	-498.95	
EFT Pymt	09/08/2013	BURTONS WELDING & REPAIR	AMENTITIES BLDG: C/BOND SHEETING FOR EVES	-594.70	
EFT Pymt	09/08/2013	CANNON HYGIENE	2013/2014 SANITARY BIN SERVICE FEE	-1,510.04	
EFT Pymt	09/08/2013	CARDELL Sarah-Ellen A	ASS 209 - REFUND	-558.05	
EFT Pymt	09/08/2013	CENTRAL COUNTRY ZONE WALGA	13/14 ANNUAL SUBSCRIPTION	-3,740.00	

TYPE	DATE	PAYEE	DETAILS	AMT PAID	TOTALS
EFT Pymt	09/08/2013	COLONIAL FIRST STATE-CORRIGAN Justin	SUPER CONTRIB: FE 30 JUL 13	-277.54	
EFT Pymt	09/08/2013	COLONIAL FIRST STATE-MOULTON Clare	SUPER CONTRIB: FE 30 JUL 13	-65.69	
EFT Pymt	09/08/2013	COUNTRY COPIERS NORTHAM	ASSET : KYOCERA FS 1320DN PRINTER	-441.10	
EFT Pymt	09/08/2013	COURIER AUSTRALIA/TOLL IPEC	FREIGHT CHARGES: 19 - 25 JUL 13	-66.46	
EFT Pymt	09/08/2013	CSRF - CATHOLIC SUPER & RETIREMENT FUND	SUPER CONTRIB: FE 30 JUL 13	-114.31	
EFT Pymt	09/08/2013	DOMINION SUPERANNUATION MASTER TRUST	SUPER CONTRIB: FE 30 JUL 13	-98.55	
EFT Pymt	09/08/2013	DOWNER EDI WORKS	RD MTCE: 4 x CATIONIC RAPID SET	-1,116.72	
EFT Pymt	09/08/2013	DPT of LANDS	RES AVON LOC 27959 - LEASE RH701566: JAN 12 to JUN 13	-13,200.00	
EFT Pymt	09/08/2013	ELDERS RURAL SERVICES AUST LTD	RTR YORK WILLIAMS RD2 & RD MTNCE: SUPPLIES	-2,021.90	
EFT Pymt	09/08/2013	GSA ENGINEERING	BEV OVAL & REC CENTRE: FINAL PYMT SCHEMATIC DESIGN ETC	-1,089.00	
EFT Pymt	09/08/2013	HITACHI CONSTRUCTION MACHINERY (AUST) P/L	VARIOUS VEHICLES: PARTS	-2,975.67	
EFT Pymt	09/08/2013	HUTCHINSON James	TRAVEL CLAIM: FIRE FIGHTING COURSE, YORK - 20 JUN 2013	-75.00	
EFT Pymt	09/08/2013	IFAP	13/14 ANNUAL MEMBERSHIP	-407.00	
EFT Pymt	09/08/2013	KINETIC SUPER (ACCTS SUPER)	SUPER CONTRIB: FE 30 JUL 13	-83.93	
EFT Pymt	09/08/2013	LANDGATE (DOLA)	TITLE SEARCHES	-24.00	
EFT Pymt	09/08/2013	LANDGATE (VGO)	VALUATION FEES: UV & MINING TENEMENTS: 14 JUN - 15 JUL 13	-148.30	
EFT Pymt	09/08/2013	LGIS INSURANCE BROKING	13/14 INSURANCE (1 of 2 PYMTS)	-41,626.02	
EFT Pymt	09/08/2013	LGISWA	13/14 INSURANCE (1 of 2 PYMTS)	-92,639.95	
EFT Pymt	09/08/2013	LGMA	GRANTS W/SHOP - 22 AUG 13 & CEO 13/14 MEMBERSHIP	-618.00	
EFT Pymt	09/08/2013	LGSA - LOC GOV SUPERS ASSOC	WORKS CON: 15-16 AUG 13 & 13/14 MEMBERSHIP	-883.50	
EFT Pymt	09/08/2013	LHAAC - LOC HLTH AUTH ANALYTICAL COM	2013/14 SUBSCRIPTION	-509.96	

TYPE	DATE	PAYEE	DETAILS	AMT PAID	TOTALS
EFT Pymt	09/08/2013	LnC HYDRAULICS	NEW SPORTS COMPLEX: DESIGN WORKS for AMALGATED LOTS	-5,940.00	
EFT Pymt	09/08/2013	McLEODS BARRISTERS & SOLICITORS	BEV STN ARTS INC & BEV SOARING SOC: LEASE REVIEWS	-660.55	
EFT Pymt	09/08/2013	MSA CONSTRUCTION	2013-07 JUL RELIEF "BUILDING INSPECTOR"	-2,046.00	
EFT Pymt	09/08/2013	MURRAY Keith	REIMBURSEMENT: LOC GOV WEEK - 7-9 AUG 13: PARKING	-21.30	
EFT Pymt	09/08/2013	NATWAY FURNITURE & CONSTRUCTIONS	DR'S SURGERY: MAINTENANCE	-151.25	
EFT Pymt	09/08/2013	ORICA/SPECTRUM	2013-07 JUL CHLORINE CYLINDER RENTAL (ORICA)	-42.28	
EFT Pymt	09/08/2013	QUAIRADING SMASH REPAIRS	BEV0 (SDN26): REPAIRS	-1,057.13	
EFT Pymt	09/08/2013	QUICK CORP AUST	JUL 2013 STATIONERY ORDER	-1,335.65	
EFT Pymt	09/08/2013	RADIOWEST BROADCASTERS P/L	2013-06 JUN & 2013-07 JUL: INTERVIEW "AROUND THE TOWN" INTERVIEWS	-110.00	
EFT Pymt	09/08/2013	ROCLA PIPELINE PRODUCTS	VARIOUS RDS: PIPING	-6,301.53	
EFT Pymt	09/08/2013	ROSHER E & MJ	ASSET 8704 : SLASHER 3 POINT	-3,025.00	
EFT Pymt	09/08/2013	RURAL PRESS REGIONAL MEDIA WA P/L (THE AD	ADVERTISING: POS VACANT - MNTCE OFFICER	-201.50	
EFT Pymt	09/08/2013	SHIRE OF BROOKTON	2013-07 JUL TOWN PLANNING SCHEME	-9,398.72	
EFT Pymt	09/08/2013	SHIRE OF QUAIRADING	SEAVROC - ENVIRONMENT SERVICES 12/13 - FINAL PYMT	-20,900.00	
EFT Pymt	09/08/2013	SUPERWRAP - PERSONAL SUPER PLAN	SUPER CONTRIB: FE 30 JUL 13	-703.86	
EFT Pymt	09/08/2013	TOTAL EDEN	59 SMITH ST: RETIC REPAIRS	-186.27	
EFT Pymt	09/08/2013	TTFS - THE TEMP FENCE SHOP	RD MTCE: TEMPORARY FENCING	-3,289.00	
EFT Pymt	09/08/2013	UWA - UNI OF WA	UWA "BEV DESIGN STUDIO": COMMENCEMENT - 1 OF 2 PYMTS	-2,750.00	
EFT Pymt	09/08/2013	WALGA - WA LOCAL GOVERNMENT ASSOCIATION	13/14 MEMBERSHIP FEES	-26,072.61	
EFT Pymt	09/08/2013	WALGSP - SUPER	SUPER CONTRIB: FE 30 JUL 13	-5,027.92	
EFT Pymt	09/08/2013	WILSON Michael	2013-08 AUG BLARNEY ISSUE	-250.00	-306,900.88

TYPE	DATE	PAYEE	DETAILS	AMT PAID	TOTALS
Liability Chq	15/08/2013	AUST SUPER	SUPER CONTRIB: FE 13 AUG 13	0.00	0.00
Liability Chq	15/08/2013	BT FIN GP-LEONHARDT Scott	SUPER CONTRIB: FE 13 AUG 13	0.00	0.00
Liability Chq	15/08/2013	COLONIAL FIRST STATE-CORRIGAN Justin	SUPER CONTRIB: FE 13 AUG 13	0.00	0.00
Liability Chq	15/08/2013	COLONIAL FIRST STATE-MOULTON Clare	SUPER CONTRIB: FE 13 AUG 13	0.00	0.00
Liability Chq	15/08/2013	CSRF - CATHOLIC SUPER & RETIREMENT FUND	SUPER CONTRIB: FE 13 AUG 13	0.00	0.00
Liability Chq	15/08/2013	DOMINION SUPERANNUATION MASTER TRUST	SUPER CONTRIB: FE 13 AUG 13	0.00	0.00
Liability Chq	15/08/2013	ENTERPRISE SUPER	SUPER CONTRIB: FE 13 AUG 13	0.00	0.00
Liability Chq	15/08/2013	KINETIC SUPER (ACCTS SUPER)	SUPER CONTRIB: FE 13 AUG 13	0.00	0.00
Liability Chq	15/08/2013	SHIRE OF BEVERLEY	2013-08 AUG SAL DEDUCTIONS (13 AUG): RATES	0.00	0.00
Liability Chq	15/08/2013	SUPERWRAP - PERSONAL SUPER PLAN	SUPER CONTRIB: FE 13 AUG 13	0.00	0.00
Liability Chq	15/08/2013	WALGSP - SUPER	SUPER CONTRIB: FE 13 AUG 13	0.00	0.00
EFT Pymt	19/08/2013	BT FIN GP-LEONHARDT Scott	SUPER CONTRIB: FE 13 AUG 13	-173.34	
EFT Pymt	19/08/2013	COLONIAL FIRST STATE-CORRIGAN Justin	SUPER CONTRIB: FE 13 AUG 13	-277.54	
EFT Pymt	19/08/2013	COLONIAL FIRST STATE-MOULTON Clare	SUPER CONTRIB: FE 13 AUG 13	-82.11	
EFT Pymt	19/08/2013	COURIER AUSTRALIA/TOLL IPEC	FREIGHT CHARGES: 19 JUL - 08 AUG 13	-36.62	
EFT Pymt	19/08/2013	CSRF - CATHOLIC SUPER & RETIREMENT FUND	SUPER CONTRIB: FE 13 AUG 13	-114.31	
EFT Pymt	19/08/2013	DOMINION SUPERANNUATION MASTER TRUST	SUPER CONTRIB: FE 13 AUG	-82.11	
EFT Pymt	19/08/2013	ENTERPRISE SUPER	SUPER CONTRIB: FE 13 AUG 13	-86.33	
EFT Pymt	19/08/2013	HEMPFIELD SMALL ENGINE	BE1727 (AC01) & SP01 (CHAINSAWS): PARTS	-442.95	
EFT Pymt	19/08/2013	HITACHI CONSTRUCTION MACHINERY (AUST) P/L	VARIOUS VEHICLES: PARTS	-563.16	
EFT Pymt	19/08/2013	KINETIC SUPER (ACCTS SUPER)	SUPER CONTRIB: FE 13 AUG 13	-67.77	

TYPE	DATE	PAYEE	DETAILS	AMT PAID	TOTALS
EFT Pymt	19/08/2013	KLEENHEAT GAS (WESFARMERS KLEENHEAT GAS P	13/14 FEES for 2.75kL BULK TANK	-699.60	
EFT Pymt	19/08/2013	MARSHALL Simon	REIMBURSE: ULP 20.02 L	-30.01	
EFT Pymt	19/08/2013	McLEODS BARRISTERS & SOLICITORS	BEV STATION ARTS INC: LICENSE AGREEMENT	-279.65	
EFT Pymt	19/08/2013	SUPERWRAP - PERSONAL SUPER PLAN	SUPER CONTRIB: FE 13 AUG 13	-703.86	
EFT Pymt	19/08/2013	WALGA - WA LOCAL GOVERNMENT ASSOCIATION	2013/14 SUBS - PROCUREMENT CONSULTANCY (U/PAID)	-99.00	
EFT Pymt	19/08/2013	WALGSP - SUPER	SUPER CONTRIB: FE 13 AUG 13	-4,992.79	-8,731.15
Direct Debit	19/08/2013	3 MESSAGING	3 MESSAGING: 2013-08 AUG SMS SERVICE FEE	-82.50	-82.50
EFT Pymt	27/08/2013	BDH - BEV DOME HIRE	DIESEL: 8,000 L	-12,118.40	
EFT Pymt	27/08/2013	BOULTON Kim	RECORD MANAGEMENT ASSISTANCE	-3,569.50	
EFT Pymt	27/08/2013	CAMPION LE & JM	ASS 1424 - REFUND	-345.26	-16,033.16
Liability Chq	29/08/2013	ATO - AUSTRALIAN TAX OFFICE	2013-08 AUG PAYG TAX	0.00	0.00
Liability Chq	29/08/2013	AUST SUPER	SUPER CONTRIB: FE 27 AUG 13	0.00	0.00
Liability Chq	29/08/2013	BT FIN GP-LEONHARDT Scott	SUPER CONTRIB: FE 27 AUG 13	0.00	0.00
Liability Chq	29/08/2013	COLONIAL FIRST STATE-CORRIGAN Justin	SUPER CONTRIB: FE 27 AUG 13	0.00	0.00
Liability Chq	29/08/2013	COLONIAL FIRST STATE-MOULTON Clare	SUPER CONTRIB: FE 27 AUG 13	0.00	0.00
Liability Chq	29/08/2013	CSRF - CATHOLIC SUPER & RETIREMENT FUND	SUPER CONTRIB: FE 27 AUG 13	0.00	0.00
Liability Chq	29/08/2013	DOMINION SUPERANNUATION MASTER TRUST	SUPER CONTRIB: FE 27 AUG 13	0.00	0.00
Liability Chq	29/08/2013	ENTERPRISE SUPER	SUPER CONTRIB: FE 27 AUG 13	0.00	0.00
Liability Chq	29/08/2013	KINETIC SUPER (ACCTS SUPER)	SUPER CONTRIB: FE 27 AUG 13	0.00	0.00
Liability Chq	29/08/2013	LGRCEU	2013-08 AUG UNION FEES	0.00	0.00
Liability Chq	29/08/2013	SHIRE OF BEVERLEY	2013-08 AUG SAL DEDUCTIONS (27 AUG): RATES	0.00	0.00

TYPE	DATE	PAYEE	DETAILS	AMT PAID	TOTALS
Liability Chq	29/08/2013	SUPERWRAP - PERSONAL SUPER PLAN	SUPER CONTRIB: FE 27 AUG 13	0.00	0.00
Liability Chq	29/08/2013	WALGSP - SUPER	SUPER CONTRIB: FE 27 AUG 13	0.00	0.00
Direct Debit	31/08/2013	DPI - LICENSING SERVICES	JUL/AUG 13 LICENSING PAYMENTS	-59,711.70	-59,711.70
Cheque # 1086	09/08/2013	ACMA - AUST COMM & MEDIA AUTH	LAND MOBILE APPART LIC - BEAMING HILL, SHEAHANS ROAD	-101.00	-101.00
Cheque # 1087	09/08/2013	AUST SUPER	SUPER CONTRIB: FE 30 JUL 13	-185.17	-185.17
Cheque # 1088	09/08/2013	BEV MED PRACTICE - ADEBAYO	PRE-EMPLOYMENT MEDICAL: BURTON Daryle	-120.00	-120.00
Cheque # 1089	09/08/2013	SYNERGY	L78 WATERHATCH RD, COUNCIL DAM: 14 MAY - 26 JUL 13	-273.30	-273.30
Cheque # 1090	09/08/2013	T-BONE & SON	UWA "BEVERLEY DESIGN STUDIO": REFRESHMENTS - 03 AUG 13	-40.50	-40.50
Cheque # 1091	09/08/2013	TELSTRA	2013-08 AUG TELEPHONE ACCOUNTS	-1,294.85	-1,294.85
Cheque # 1092	19/08/2013	ATO - AUSTRALIAN TAX OFFICE	2013-07 JUL BAS RETURN	-26,651.00	-26,651.00
Cheque # 1093	19/08/2013	AUST SUPER	SUPER CONTRIB: FE 13 AUG 13	-113.23	-113.23
Cheque # 1094	19/08/2013	ORIGIN ENERGY	5 WRIGHT ST: 13/14 GAS CYLINDER RENTAL	-29.00	-29.00
Cheque # 1095	19/08/2013	WATER CORPORATION	2013-08 AUG WATER ACCOUNTS	-15,394.05	-15,394.05
Cheque # 1096	27/08/2013	RUGGLES Jim	ASS 1251 - REFUND	-436.14	-436.14
Cheque # 1097	27/08/2013	SYNERGY	STREET LIGHTS JUL 13 & L36 FORREST ST: 10 JUL - 13 AUG 13	-3,122.65	-3,122.65
Cheque # 1098	27/08/2013	WATER CORPORATION	REC GROUNDS SUBDIVSION: INFRASTRUCTURE CONTRIBUTION	-8,280.30	-8,280.30
Gen Jnl 2593	12/08/2013		JUL 13 # - CREDIT CARD	-3,654.50	-3,654.50
PAYMENTS RAISED IN CURRENT MONTH				-451,441.34	-451,441.34

TYPE	DATE	PAYEE	DETAILS	AMT PAID	TOTALS
WAGES & SALARIES					
EFT Pymt	1/08/2013	WAGES & SALARIES	FE - 30/07/2013	-46,789.38	
	15/08/2013	WAGES & SALARIES	FE - 13/08/2013	-46,746.39	
EFT Pymt	29/08/2013	WAGES & SALARIES	FE - 27/08/2013	-47,737.27	
			WAGES & SALARIES	-141,273.04	-141,273.04
TRANSFERS to TRUST					
			TRANSFERS to TRUST	0.00	0.00
UNPRESENTED PAYMENTS for CURRENT BANK STATEMENT					
Cheque # 1096	27/08/2013	RUGGLES Jim	ASS 1251 - REFUND	436.14	
Cheque # 1098	27/08/2013	WATER CORPORATION	REC GROUNDS SUBDIVISION: INFRASTRUCTURE CONTRIBUTION	8,280.30	
			UNPRESENTED PAYMENTS for CURRENT BANK STATEMENT	8,716.44	8,716.44
PAYMENTS PRESENTED IN CURRENT BANK # RELATING to PRIOR MONTHS' TRANSACTIONS					
			PAYMENTS PRESENTED IN CURRENT BANK # RELATING to PRIOR MONTHS' TRANSACTIONS	0.00	0.00
OTHER AMENDMENTS/GENERAL JOURNALS					
			OTHER AMENDMENTS/GENERAL JOURNALS	0.00	0.00
INVESTMENTS					
			INVESTMENTS	0.00	0.00
			TOTAL EXPENDITURE for MUNICIPAL ACCOUNT		-583,997.94

TYPE	DATE	PAYEE	DETAILS	AMT PAID	TOTALS
CREDIT CARD PAYMENT SUMMARY for CURRENT BANK STATEMENT					
Bill Pmt - CCard	02/07/2013	MATILDA BAY TEAROOMS	UWA MEET: TOWNSCAPE WORKS - 02 JUL 13	14.50	
Bill Pmt - CCard	05/07/2013	JB HI-FI	NEW SPORT COMPLEX: 2 x WALL MOUNT LCD COLOUR TVs	3,640.00	
CREDIT CARD PAYMENT SUMMARY for CURRENT BANK STATEMENT				3,654.50	
TRUST ACCOUNT DETAILS					
PAYMENTS RAISED IN CURRENT MONTH					
EFT Pymt	9/08/2013	WILKINSON Zoe	REFUND-GYMKEYBOND	-30.00	
EFT Pymt	9/08/2013	SWAN Olive	REFUND-GYMKEYBOND	-30.00	
EFT Pymt	9/08/2013	SMITH Diana	REFUND-GYMKEYBOND	-30.00	
EFT Pymt	9/08/2013	OWENS Fran (for James Owens)	REFUND-GYMKEYBOND	-30.00	
EFT Pymt	9/08/2013	HAGAN Darrell	REFUND-GYMKEYBOND	-30.00	-150.00
PAYMENTS RAISED IN CURRENT MONTH				-150.00	-150.00
PAYMENTS UNPRESENTED IN CURRENT BANK #					
PAYMENTS UNPRESENTED IN CURRENT BANK #				0.00	0.00
PAYMENTS PRESENTED IN CURRENT BANK # RELATING to PRIOR MONTHS' TRANSACTIONS					
PAYMENTS PRESENTED IN CURRENT BANK # RELATING to PRIOR MONTHS' TRANSACTIONS				0.00	0.00
OTHER AMENDMENTS/GENERAL JOURNALS					
OTHER AMENDMENTS/GENERAL JOURNALS				0.00	0.00
TOTAL EXPENDITURE for TRUST ACCOUNT					-150.00
TOTAL EXPENDITURE as reconciled to the AUGUST 2013 BANK STATEMENTS					
				Municipal Account Expenditure	-583,997.94
				Trust Account Expenditure	-150.00
TOTAL EXPENDITURE for AUGUST 2013					-587,147.94

12. ADMINISTRATION

12.1 Repairs to Former Child Health Clinic, 141 Vincent Street

SUBMISSION TO: Ordinary Council Meeting 24 September 2013
REPORT DATE: 17 September 2013
APPLICANT: N/A
FILE REFERENCE: ADM 0050
AUTHOR: SP Gollan, Chief Executive Officer
ATTACHMENTS: Report from ADC Projects

SUMMARY

Council to consider the future of the former Child Health Clinic building.

BACKGROUND

Council in May 2010 agreed to allow the Beverley Hospital Auxiliary to use the former Child Health Clinic as their Opportunity Shop, prior to the group using this venue, building works were undertaken to make it more user friendly for the group.

COMMENT

The Beverley Hospital Auxiliary has advised Council that since moving into this venue they have increased their revenue significantly due to the location.

However the building has had a number of structural issues that needed to be investigated.

Council contracted ADC Projects to undertake an assessment of the building and provide advice on the cost to repair the building. I have received the report which is attached.

The report indicates that repairs will cost in the vicinity of \$330,000.00 and to rebuild a similar building would cost \$625,000.00.

The Asset Management Plan (November 2011) indicates that the Child Health Clinic had a condition rating of 4 being fair to minus and had 0 – 19% remaining of its estimated economic working life.

I have discussed the report provided by ADC Projects with the Beverley Hospital Auxiliary at their recent meeting. During discussions the question on whether the building would be repaired was raised with my response being that I could not say one way or the other but suggested that they look into finding a new facility, should the decision be that the building not be repaired. The meeting agreed that they would start to investigate different options available. I also advised that Council has no other buildings available.

STATUTORY ENVIRONMENT

N/A

FINANCIAL IMPLICATIONS

Funds have been allocated in the 2013/2014 budget for repair works totalling \$30,000.00.

STRATEGIC IMPLICATIONS

Our Goals – Economic – Manage our assets sustainably.

POLICY IMPLICATIONS

Nil

VOTING REQUIREMENTS

Simple Majority

OFFICER'S RECOMMENDATION

That:

1. Remedial repair works to the Child Health Clinic not be undertaken; and
2. The Beverley Hospital Auxiliary be advised that repair works to the Child Health Clinic will not be undertaken and they seek alternative premises to operate the Opportunity Shop.

COMMITTEE'S RECOMMENDATION

M10/0913

Moved Cr Gogol

Seconded Cr Pepper

That:

1. Remedial repair works to the Child Health Clinic not be undertaken; and
2. The Beverley Hospital Auxiliary be advised that repair works to the Child Health Clinic will not be undertaken and they seek alternative premises to operate the Opportunity Shop.

CARRIED 8/0

Attachment 12.1

ADC PROJECTS

ARCHITECTURE & PROJECT MANAGEMENT SERVICES

8th August 2013

The Chief Executive Officer
Shire of Beverley
136 Vincent Street
BEVERLEY WA 6304

Attention Mr Steve Gollan

Dear Steve

Re: **FORMER CHILD HEALTH CLINIC : 141 VINCENT STREET, BEVERLEY**

As requested, attached are comparative costs to repair the existing building only to a safe and sound condition or to construct a new equivalent sized multi-purpose community building on the same site.

It should be well noted that the repair cost does not include for any modifications to the existing layout, facilities or fixtures and fittings. The existing building does not comply with the current BCA standards, particularly with regard to mobility access and facilities. The existing room arrangement is also inflexible and does not reasonably allow for multi-use and/or concurrent use, nor for meetings of more than a few people in any one room.

To bring the existing building up to BCA compliance the scope of modifications would include:-

- Providing mobility access
- Providing mobility amenities
- Providing child friendly amenities
- Providing a modern kitchen it might also include
- Services upgrades including electrical wiring and lighting
- Wall and ceiling insulation

For flexibility of use the scope of work could also encompass:-

- Enclosing and levelling the rear verandah as additional space
- Removing part of the central wall in order to link the existing larger front and back rooms together to cater for meetings
- Providing storage and fixed display units to allow multiple and concurrent use of the facilities
- New floor finishes
- New window treatments
- Upgrades to airconditioning and ventilation

The cost of this additional work when added to the repairs estimate would approach the indicative replacement cost. Therefore, the relative value of simply repairing the existing facility compared to either repairing and upgrading it or replacing it needs to be assessed.

While we understand that the existing building is not heritage listed it does form a recognisable component of the Beverley cultural precinct at the western end of Vincent Street so the intrinsic value of its retention would also need to be weighed up against the efficiency of a new construction.

We have suspended any further work on arranging repairs to the building pending the Shire's consideration of these costings and your further instruction.

Yours faithfully

BRIAN ADCROFT

Attachment 12.1



7 August 2013

ADC Projects
544 Newcastle Street
West Perth WA 6005

Attention: Mr B. Adcroft

Dear Sir

BEVERLEY COMMUNITY BUILDING

Herewith our Indicative Cost Estimates for the above project.

As requested we have estimated the options of repairs to the existing building and the cost of a new replacement building.

The estimate includes construction costs, contingencies, fees and cost escalation. Loose furniture and equipment is excluded.

Please contact us if you have any questions.

Yours faithfully
Ralph Beattie Bosworth

A handwritten signature in blue ink, appearing to read 'Kevin Daniels', is written over a light blue circular stamp.

Kevin Daniels
Director

Ralph Beattie Bosworth
Construction Cost Consultants
Ralph & Beattie Bosworth Pty Ltd as trustee for the Ralph & Beattie
Unit Trust No. 2 ABN 58 260 502 981

12 Kings Park Road West Perth Western Australia 6005
PO Box 456 West Perth Western Australia 6872
Telephone 08 9321 2777 Facsimile 08 9481 1783
Email info@rbb.com.au www.rbb.com.au

G:\Corresp\Sec\2013\19101-19200\191241-kjd.docx

Attachment 12.1

BEVERLEY COMMUNITY BUILDING

7 AUGUST 2013

REPAIRS TO EXISTING BUILDING

Estimate as attached	\$ 155,000
Builders Preliminaries (15%)	23,000
Builders Margin (7.5%)	14,000
Location Allowance (15%)	30,000
Design Contingency (15%)	35,000
Sub-Total	\$ 257,000
Construction Contingency (10%)	26,000
Consultants Fees (15%)	43,000
Cost Escalation (6 months) (1.5%)	4,000
ESTIMATED TOTAL PROJECT COST	\$ 330,000
GST excluded	\$ 33,000

NEW REPLACEMENT BUILDING

Estimate as attached	\$ 430,000
Builders Preliminaries	incl
Builders Margin	incl
Location Allowance (15%)	65,000
Design Contingency (15%)	37,000
Sub-Total	\$ 532,000
Construction Contingency (5%)	26,000
Consultants Fees (10%)	56,000
Cost Escalation (6 months) (1.5%)	11,000
ESTIMATED TOTAL PROJECT COST	\$ 625,000
GST excluded	\$ 62,500

12.2 Independent Living Units

SUBMISSION TO: Ordinary Council Meeting 24 September 2013
REPORT DATE: 17 September 2013
APPLICANT: N/A
FILE REFERENCE: ADM 0366
AUTHOR: SP Gollan, Chief Executive Officer
ATTACHMENTS: Report from Dominic Carbone and Associates
(Presented Under Separate Cover)

SUMMARY

Council to consider marketing the Independent Living Units by a Real Estate Agent.

BACKGROUND

Following the adoption of a Business Plan, for the development of Residential Accommodation for Retirees (Independent Living Units (ILU's)) tenders were called for 2 and 4 units.

Council awarded the contract to LR Sims Co. for the construction of two Retirement Units at 45-49 Dawson Street for \$640,440.00 (GST inclusive) in September 2010.

COMMENT

Council, at their February 2012 Council meeting resolved as follows:

1. *That the Marketing Plan be endorsed.*
2. *That general Marketing arrangements be referred to the Chief Executive Officer in consultation with the Shire President.*
3. *That the Shire President and Chief Executive be authorised to execute (sign and seal) Lease Documents prepared by Council Solicitors, in accordance with the approved Business Plan.*
4. *That an unbudgeted allocation of \$3,000.00 be set aside for marketing and promotion.*
5. *The entry fee of \$300,000 and retention fee of 20% as prescribed in the Residence Contract is confirmed.*
6. *Retention of 20% of the Entry Fee is retained and reset from 5 years to 10 years as follows:*
 - 5% Year 1;*
 - 3% Year 2;*
 - 1.5% for each of the following 8 years; and*
 - Total Retention – 20% as prescribed in the Residence Contract.*
7. *That the Entry Fee of \$300,000.00 be reviewed from time to time.*
8. *Based on a review and update of Operating Costs the weekly operating fee for year one is reset to \$66.00, (\$3,422.00 per annum) and subject to an annual review.*

9. *The Residents Contract and associated documentation be referred to Council's Solicitors to be amended (and corrected) as necessary and as instructed by the Chief Executive Officer.*

The marketing to date has been undertaken by Council and has been unsuccessful in attracting tenants to the units.

York Estate Agents were approached regarding providing a Property Market Appraisal for 49A and 49B Dawson Street.

The report advised that the market value for these properties would be in the vicinity of \$260,000.00 to \$270,000.00 freehold each. York Estate Agents also assessed the properties under a "Lease for Life" arrangement and felt an ingoing fee of \$200,000.00 would be more realistic.

Council has had discussions on the best way forward and has agreed in principal to reduce the "Entry Fee" to \$200,000.00 and retain \$60,000.00 over a 10 year period.

This information has been forwarded onto Dominic Carbone and Associates to review the business plan to make sure that the changes comply with all relevant legislation and to provide options in relation to the entry fee and retained amount based on current calculations of \$60,000.00 over a period of ten (10) years. At the time of writing this agenda item the report was unavailable and will be tabled at the meeting. I believe the marketing of these Units be undertaken by a Real Estate Agency.

STATUTORY ENVIRONMENT

Retirement Village Act 1992
Retirement Village Regulations 1992

FINANCIAL IMPLICATIONS

Funds have been allocated in the 2013/2014 budget towards the Independent Living Units

STRATEGIC IMPLICATIONS

Planned Development – Enable diverse and affordable housing.

POLICY IMPLICATIONS

N/A

VOTING REQUIREMENTS

Absolute Majority

OFFICER'S RECOMMENDATION

That Council:

1. Set the Entry Fee at \$200,000.00;
2. Set the Retention Fee at \$60,000.00 over a 10 year period; and
3. Seek quotes for the marketing of the Independent Living Units by a Real Estate Agency and the Chief Executive Officer be authorised to appoint a Real Estate Agency to undertake the marketing of the units.

MOTION

M11/0913

Moved Cr Pepper

Seconded Cr Gogol

That Council:

1. **Set the Entry Fee at \$200,000.00;**
2. **Set the Retention Fee at \$60,000.00 over a 10 year period; and**
3. **Seek quotes for the marketing of the Independent Living Units by a Real Estate Agency and the Chief Executive Officer be authorised to appoint a Real Estate Agency to undertake the marketing of the units.**

AMENDMENT

Moved Cr White

Seconded Cr Pepper

That part 1 of the motion be amended by deleting the amount of \$200,000.00 and replacing it with \$180,000.00

CARRIED 5/3

The amendment became the motion.

COUNCIL RESOLUTION

M12/0913

The Chairperson put the amended motion:

That Council:

1. **Set the Entry Fee at \$180,000.00;**
2. **Set the Retention Fee at \$60,000.00 over a 10 year period; and**
3. **Seek quotes for the marketing of the Independent Living Units by a Real Estate Agency and the Chief Executive Officer be authorised to appoint a Real Estate Agency to undertake the marketing of the units.**

CARRIED 6/2

12.3 Authorised Officers – Cat Act 2011

SUBMISSION TO: Ordinary Council Meeting 24 September 2013
REPORT DATE: 17 September 2013
APPLICANT: N/A
FILE REFERENCE: ADM 0297
AUTHOR: SP Gollan, Chief Executive Officer
ATTACHMENTS: Nil

SUMMARY

That Council consider appointing authorised officers under the Cat Act 2011.

BACKGROUND

The State Government have introduced the Cat Act 2011 which comes into force on the 1st of November 2013.

COMMENT

Under the Cat Act 2011, Council is to appoint Authorised Officers to carry out the requirements of the Act. The Cat Act 2011 is to provide for the control and management of cats and to promote and encourage responsible cat ownership.

York Shire Rangers Matthew Sharpe and Daniel Birleson along with two staff members in Malcolm Kehlet and Ethan Moad have been nominated as authorised officers

STATUTORY ENVIRONMENT

The Cat Act 2011 states the following:

Division 3 — Authorised persons

Subdivision 1 — Appointment of authorised persons

48. Authorised persons

(1) A local government may, in writing, appoint persons or classes of persons to be authorised for the purposes of performing particular functions under this Act.

(2) A person who is not an employee of a local government cannot be appointed to be an authorised person for the purposes of section 62.

(3) An authorisation under this section may be made on such conditions as the local government determines, in writing given to the authorised person.

(4) The local government may, in writing given to the authorised person, at any time, cancel an authorisation under this section or add, vary or cancel a condition of an authorisation.

(5) The local government is to issue to each authorised person appointed under subsection (1) a certificate stating that the person is an authorised person for the purposes of this Act.

(6) An authorised person appointed under subsection (1) must —

- (a) carry the certificate at all times when exercising powers or performing functions as an authorised person; and
- (b) produce for inspection the certificate at the reasonable request of any person; and
- (c) if he or she ceases to be an authorised person, return the certificate to the local government as soon as is practicable.

Penalty: a fine of \$5 000.

Subdivision 2 — Particular powers of authorised persons

49. Authorised person may cause a cat to be destroyed

(1) An authorised person may cause a cat to be destroyed in a humane manner —

- (a) if the person believes on reasonable grounds that the cat —
 - (i) is feral, diseased or dangerous; and
 - (ii) has caused or given, or is likely to cause or give, serious injury, or serious illness, to a person, another animal or itself; or
- (b) at the request of the owner of the cat; or
- (c) in the circumstances, if any, prescribed.

(2) The owner of a cat destroyed under this section is liable to pay to the local government that appointed the authorised person the reasonable costs associated with the destruction and the disposal of the cat.

(3) The local government may recover the amount of the costs referred to in subsection

(2) from the owner of the cat in a court of competent jurisdiction.

POLICY IMPLICATIONS

N/A

FINANCIAL IMPLICATIONS

There will be a cost associated with advertising the Gazettal notices in the Government Gazette. A budget allocation for advertising has been included in the 2013/14 budget.

STRATEGIC IMPLICATIONS

N/A

VOTING REQUIREMENTS

Absolute majority.

OFFICER'S RECOMMENDATION

That Council approve the appointments of Matthew Sharpe, Daniel Birleson, Malcolm Kehlet and Ethan Moad as Authorised Officers under the Cat Act 2011, for the enforcement of both the Cat Act 2011 and the Cat Regulations 2012.

COUNCIL RESOLUTION

M13/0913

Moved Cr Foster

Seconded Cr Gogol

That Council approve the appointments of Matthew Sharpe, Daniel Birleson, Malcolm Kehlet and Ethan Moad as Authorised Officers under the Cat Act 2011, for the enforcement of both the Cat Act 2011 and the Cat Regulations 2012.

CARRIED 8/0

12.4 Community Sporting and Recreation Facilities Fund Grant Application

SUBMISSION TO: Ordinary Council Meeting 27 August 2013
REPORT DATE: 20 August 2013
APPLICANT: Shire of Beverley
FILE REFERENCE: ADM 0416
AUTHOR: SP Gollan, Chief Executive Officer
ATTACHMENTS: Nil

SUMMARY

The Shire of Beverley has prepared a Grant Application to Community Sporting and Recreation Facilities Fund (CSRFF) for funding to support the upgrade of light towers at the Beverley Oval.

BACKGROUND

In 2011 the Shire was successful in obtaining a grant for erecting the new building at the Recreation Ground through the CSRFF.

To complete the upgrade of the Recreation Ground, Council has agreed to construct three new light towers to compliment the new tower that formed part of the building construction project.

COMMENT

Council has placed an allocation to construct the lighting towers in their 2013/14 budget.

The installation of three new light towers will enhance our facilities and allow for sporting activities to be played at night. The lights will illuminate the oval to an average of 200 lux.

To assist with the application letters of support have been received from the Avon Cricket Association, Avon Hockey Association and the Avon Football Association.

Graeme McDonald of Inkosi Design has prepared the plans and drawings for the towers and has also received some indicative costings to assist with the grant application. Council will need to call tenders as prices received are above the tender threshold under the Local Government Act 1995.

A budget for the project is shown below:

Lighting Towers along with electrical works	\$157,050.00 (ex GST)
Earthworks (Footings, trenching etc)	\$ 25,000.00 (ex GST)
Consultant Fees (Designs, Project Management)	\$ 10,000.00 (ex GST)
Signage	\$ 500.00 (ex GST)
Cost Escalation	\$ 7,702.00
Total	\$200,252.00

STATUTORY ENVIRONMENT

Nil

FINANCIAL IMPLICATIONS

Funds have been allocated in the 2013/14 Budget for the purpose of erecting three new lighting towers.

STRATEGIC IMPLICATIONS

Sustainable Infrastructure – Maintain and upgrade our assets and infrastructure – provide facilities to support sporting and community needs.

POLICY IMPLICATIONS

Nil

VOTING REQUIREMENTS

Simple Majority

OFFICER'S RECOMMENDATION

That Council

1. Endorse the CSRFF Grant Application for three (3) light towers and to prioritise the application as priority 1 of 1 application submitted for endorsement; and
2. Call tenders for the supply and installation of three (3) Lighting Towers at the Beverley Recreation Ground.

COUNCIL RESOLUTION

M14/0913

Moved Cr Gogol

Seconded Cr Shaw

That Council

1. **Endorse the CSRFF Grant Application for three (3) light towers and to prioritise the application as priority 1 of 1 application submitted for endorsement; and**
2. **Call tenders for the supply and installation of three (3) Lighting Towers at the Beverley Recreation Ground.**

CARRIED 8/0

13. NEW BUSINESS ARISING BY ORDER OF THE MEETING

New Business of an urgent matter only arising by order of the meeting.

The President, Cr Ridgway acknowledged Cr Foster's 16 years of service, and in response Cr Foster thanked the current Council and advised she has enjoyed her time and will miss being on Council.

14. CLOSURE

The Chairman declared the meeting closed at 3:18pm

I hereby certify these Minutes as being confirmed in accordance with Section 5.22 of the Local Government Act 1995.

PRESIDING MEMBER:

DATE: